



FREDERICK CLASSICAL CHARTER SCHOOL

PROGRAMMATIC DESIGN

ZAVOS ARCHITECTURE & DESIGN





323 W. Patrick Street
 Frederick, MD 21701
 (P) 301.698.0020
www.za-d.com



FREDERICK CLASSICAL CHARTER SCHOOL – PROGRAMMATING PHASE

Objective:

To provide direction for the design of the new FCCS with input from Parents, Teachers and Administration through surveys, interviews and presentations.

Important Design Considerations

- Accessibility
- Aesthetics
- Cost-Effectiveness
- Functionality
- Productivity
- Security/Safety
- Sustainability

Overview of Survey Analysis:

Based on the finding through survey responses we believe we have come up with a Programmatic layout that will meet the needs of your faculty and student body.

Through the survey results we were able to find various concerns including:

- One of the main Concerns we came across was the wide variety of age groups going to this school. It is important for a student to develop alongside his/her classmates. Keeping the different age groups, Kindergarten through 4th grade and 5th grade through 8th grade, in their own wing of the school would resolve most conflicts with differing grades. This also would allow the students of each grade to become more immersed within their classes and age group.
- Another concern was the differing levels of noise heard throughout the building. Most of the noisiest places including Band, Gym, Music class, and the cafeteria should be slightly separated from the classrooms and grouped together. This will reduce noise pollution in the classroom environment, therefore improving productivity by easing distractions
- The length from specials to classes was also a concern mentioned in our survey. While the layout of the building is unfinished, it is important to consider moving some of the universal classrooms to the center of the building

Our Research has also been very important when planning out special adjacencies. Upon looking through schools of the past and looking through Frederick Classical

Charter School's Mission Statement we found certain programmatic focuses for the design of the new school.

- The use of the library in an academic setting is important in almost all cases when growing up. Frederick Classical Charter School and its students and Teachers have shown great interest and pride their use of their current library. To even further accessibility to the library for all students and classes Centralizing the library will allow ease of use availability of the library at all points of the day.

PAGE	NAME
1	COVER SHEET
2	INTRODUCTION
3-4	PROGRAM REQUIREMENTS
5	PROGRAM LAYOUT
6-7	SURVEY RESULTS
8	RECEPTION / ADMIN
9	NURSE
10	COUNSELOR
11	SPEECH SERVICES
12	BOARD OFFICE
13	HEAD OF SCHOOL
14	CURRICULUM COORDINATOR
15	STAFF LOUNGE
16	CONFERENCE ROOM
17	MAINTENANCE
18	LIBRARY
19	BOOK STORAGE
20	MATH AND READING SPECIALIST
21	CR FOR INTERVENTION / TESTING
22	CR FOR STEM / COMPUTER LB
23	KINDERGARTEN
24	1ST GRADE
25	2ND GRADE
26	3RD GRADE
27	4TH GRADE
28	ART
29	LATIN
30	SPANISH
31	SPECIAL EDUCATION
32	5TH / 6TH GRADE SCIENCE
33	5TH / 6TH GRADE ENGLISH
34	5TH / 6TH GRADE MATHEMATICS
35	5TH / 6TH GRADE HISTORY
36	7TH / 8TH GRADE SCIENCE
37	7TH / 8TH GRADE ENGLISH
38	7TH / 8TH GRADE HISTORY
39	7TH / 8TH GRADE MATHEMATICS
40	GYM
41	PE OFFICE
42	BAND
43	MUSIC
44	CAFETERIA
45	ADJACENCIES
46	CONCEPTUAL FLOOR PLANS



323 W. Patrick Street
 Frederick, MD 21701
 (P) 301.698.0020
www.za-d.com



Program Requirements:

Area Type	Room/Area Name	Room/Area SF	ROOM Requirements	ACCOUNTED FOR IN CHURCH
Front Office	Reception/Admin Assistant	300	REQ: Reception Desk, Attendance Computer	ADDED
Front Office	Nurse	175	REQ: Sink, Bathroom, Gas Control	ADDED
Front Office	Counselor / Focus Room Suite W/ Waiting Area	150	REQ: Basic Furniture, Computer	ADDED
Front Office	Speech Services	150	REQ: Basic Furniture, Computer, Near Special ED	YES
Front Office	Board Office	150	REQ: Basic Furniture, Computer, Secure Files	ADDED
Front Office	Head of School	175	REQ: Basic Furniture, Computer	ADDED
Front Office	Curriculum Coordinator	225	REQ: Basic Furniture, Computer	YES
Staff	Staff Lounge	350	REQ: Basic Furniture, Vending Machine,	YES
Staff	Teacher Prep Room	150	REQ: Basic Furniture, Vending Machine,	YES
Staff	Conference Room	250	REQ: Conference Table, Dry Erase/ Promethium Board	YES
Staff	Maintenance/Server Room	150	REQ: Mechanical Equipment	YES
Communal	Library	830	REQ: Computers, Chalk Board/ Promethean Board, Projector	ADDED
Staff	Book Storage	250	REQ: Bookshelves	ADDED
Support	Math/Reading Specialists	125	REQ: Desks, Storage, Few Computers, Near Special ED / Speech Services	YES
Support	Math/Reading Specialists	125	REQ: Desks, Storage, Few Computers	YES
Classroom	Secondary Classroom for Intervention/Testing	300	REQ: Promethean Board, Desks, Storage, Few Computers	YES
Classroom	Secondary Classroom for STEM/Computer Lab	675	REQ: Computers, Promethean Board	YES
Classroom	Kindergarten	675	REQ: Desks, Cubbies, Sink, Bathroom, Chalk/ Dry Erase Board	YES
Classroom	Kindergarten	675	REQ: Desks, Cubbies, Sink, Bathroom, Chalk/ Dry Erase Board	YES
Classroom	1st Grade	675	REQ: Desks, Cubbies, Sink, Bathroom, Chalk/ Dry Erase Board	YES
Classroom	1st Grade	675	REQ: Desks, Cubbies, Sink, Bathroom, Chalk/ Dry Erase Board	YES
Classroom	2nd Grade	675	REQ: Desks, Cubbies, Sink, Bathroom, Chalk/ Dry Erase Board	YES
Classroom	2nd Grade	675	REQ: Desks, Cubbies, Sink, Bathroom, Dry Erase Board, Projector	YES
Classroom	3rd Grade	675	REQ: Desks, Cubbies, Sink, Bathroom, Dry Erase Board, Projector	YES
Classroom	3rd Grade	675	REQ: Desks, Cubbies, Sink, Bathroom, Dry Erase Board, Projector	YES
Classroom	4th Grade	675	REQ: Desks, Cubbies, Sink, Bathroom, Dry Erase Board, Projector	ADDED
Classroom	4th Grade	675	REQ: Desks, Cubbies, Sink, Bathroom, Dry Erase Board, Projector	ADDED
Classroom	Art	742	REQ: Promethean Board, Desks, Storage, Few Computers	YES
Classroom	Latin	675	REQ: Promethean Board, Desks, Storage, Few Computers	YES
Classroom	Spanish	500	REQ: Promethean Board, Desks, Storage, Few Computers	YES
Classroom	Special Education w/ Conference Space	500	REQ: Promethean Board, Desks, Storage, Few Computers	YES
Classroom	5th/6th Grade Science	675	REQ: Chem Storage, Gas Control, Eye Washer, Shower, Chalk Board/ Promethean Board, Projector	YES
Classroom	5th/6th Grade English Language Arts	675	REQ: Promethean Board, Desks, Storage, Few Computers	YES
Classroom	5th/6th Grade Math	675	REQ: Promethean Board, Desks, Storage, Few Computers	YES
Classroom	5th/6th Grade History	675	REQ: Promethean Board, Desks, Storage, Few Computers	YES
Classroom	7th/8th Grade Science	675	REQ: Chem Storage, Gas Control, Eye Washer, Shower, Chalk Board/ Promethean Board, Projector	YES
Classroom	7th/8th Grade English Language Arts	675	REQ: Promethean Board, Desks, Storage, Few Computers	YES
Classroom	7th/8th Grade History	675	REQ: Promethean Board, Desks, Storage, Few Computers	YES
Classroom	7th/8th Grade Math	675	REQ: Promethean Board, Desks, Storage, Few Computers	YES
Support	Band Room	850	REQ: Instrument Storage, Dry Erase/Promethean Board	YES
Gym	PE Office	150	REQ: Storage, Desks, Computers	YES
Gym	Multi-purpose Room / Gym	3,000	REQ: Utility Closet, Basketball Hoops, Volleyball Posts	YES
Support	Music	1000	REQ: Instrument Storage, Dry Erase/Promethean Board	ADDED
Communal	Cafeteria	2150	REQ: Kitchen, Foldable Tables	ADDED
Support	Middle School Lounge	280	REQ: Basic Furniture	YES
TOTAL				25,438 TO 26,527

PAGE	NAME
1	COVER SHEET
2	INTRODUCTION
3-4	PROGRAM REQUIREMENTS
5	PROGRAM LAYOUT
6-7	SURVEY RESULTS
8	RECEPTION / ADMIN
9	NURSE
10	COUNSELOR
11	SPEECH SERVICES
12	BOARD OFFICE
13	HEAD OF SCHOOL
14	CURRICULUM COORDINATOR
15	STAFF LOUNGE
16	CONFERENCE ROOM
17	MAINTENANCE
18	LIBRARY
19	BOOK STORAGE
20	MATH AND READING SPECIALIST
21	CR FOR INTERVENTION / TESTING
22	CR FOR STEM / COMPUTER LB
23	KINDERGARTEN
24	1ST GRADE
25	2ND GRADE
26	3RD GRADE
27	4TH GRADE
28	ART
29	LATIN
30	SPANISH
31	SPECIAL EDUCATION
32	5TH / 6TH GRADE SCIENCE
33	5TH / 6TH GRADE ENGLISH
34	5TH / 6TH GRADE MATHEMATICS
35	5TH / 6TH GRADE HISTORY
36	7TH / 8TH GRADE SCIENCE
37	7TH / 8TH GRADE ENGLISH
38	7TH / 8TH GRADE HISTORY
39	7TH / 8TH GRADE MATHEMATICS
40	GYM
41	PE OFFICE
42	BAND
43	MUSIC
44	CAFETERIA
45	ADJACENCIES
46	CONCEPTUAL FLOOR PLANS



323 W. Patrick Street
 Frederick, MD 21701
 (P) 301.698.0020
www.za-d.com



REDESIGNED BAPTIST CHURCH TO FIT FCCS PROGRAM		
AREA MATCH	Room/Area Name	Room/Area SF ESTIMATES
5th/6th Grade English Language Arts	ROOMS (211) / (213) / (215)	676.44
5th/6th Grade Math	ROOMS (201) / (204) / PARTIAL (202)	710.37
5th/6th Grade History	ROOMS (207) / (210)	412.35
5th/6th Grade Science	ROOMS (218) / (217)	622.11
4th Grade	ROOMS (121) / (119) / HALF (118)	643.5
4th Grade	ROOMS (114) / (113) / (118) HALF / HALF (112)	776.75
Secondary Classroom for STEM/Computer Lab	ROOMS (111) / (110) / HALF (112)	751.75
Special Education	ROOMS (236) / (234)	701.67
Teacher Prep Room	GATHERING (101)	TBD
Art	ROOMS (241) / (239) / (233)	666.28
7th/8th Grade Math	ROOMS (203) / (205)	615
Math/Reading Specialists	STORAGE (209)	142.1875
7th/8th Grade Science	ROOMS (227) / (225) / PARTIAL HALLWAY	662.92
Secondary Classroom for Intervention/Testing	ROOMS (221) / PARTIAL (222)	402.53
Library	UPPER AUDITORIUM	800
Kindergarten	PRESCHOOL (144)	767.81
Kindergarten	PRESCHOOL (142)	536.25
1st Grade	PRESCHOOL (137)	550.875
1st Grade	PRESCHOOL (134) & (139)	627.21
2nd Grade	INFANTS (129) & (135)	630.51
2nd Grade	ROOMS (248) / (250)	840.13
3rd Grade	ROOMS (237) / HALF (238)	477.78
3rd Grade	ROOMS (240) / HALF (238)	476.28
Spanish	ROOMS (245) / PARTIAL (247)	433.88
Latin	CHILDREN (247)	414.81
Band Room	REHEARSAL (124) & MUSIC STORAGE (120)	894.02
PE Office	HALF OF CRAWLERS (132)	165.2
7th/8th Grade English Language Arts	UPPER AUDITORIUM	675
7th/8th Grade History	UPPER AUDITORIUM	675
Staff Lounge	CHAPEL (228)	462
Math/Reading Specialists	STORAGE/ FUTURE SHOWERS (115)	209
Maintenance/Server Room	ROOMS STORAGE (115) & JANITOR (117)	150
Speech Services	TODDLERS (146)	160.43
Conference Room	TODDLERS (146)	251.58
Reception/Admin Assistant	VESTIBULE (100)	394.33
Cafeteria	HALF OF WORSHIP (103)	2140.16
Music	PLATFORM (140) / WORSHIP (103)	1185.49
Curriculum Coordinator	STORAGE (141) / CHECK-IN (143)	252.93
Board Office	GATHERING (101)	TBD
Head of School/Curriculum Coordinator	GATHERING (101)	TBD
Nurse	GATHERING (101)	TBD
Counselor / Focus Room Suite W/ Waiting Area	GATHERING (101)	TBD
Book Storage	UPPER AUDITORIUM	250
Gym	WORSHIP	539.365
Middle School Lounge	ROOMS (224) / HALF (223)	286.755

FIRST BAPTIST CHURCH	
Room/Area Name	Room/Area SF
CRAWLERS (132)	330.4
INFANTS (129)	313.63
INFANTS (135)	316.88
PRESCHOOL (139)	328.83
PRESCHOOL (137)	550.875
PRESCHOOL (134)	298.38
PRESCHOOL (142)	536.25
PRESCHOOL (144)	767.81
BAPTISMAL (127)	85.25
KITCHEN (106)	641.45
GATHERING (101)	1502.5
VESTIBULE (100)	394.33
MIDDLE SCHOOL (110)	352
MIDDLE SCHOOL (111)	260
MIDDLE SCHOOL (112)	279.5
STORAGE (113)	143.25
HIGH SCHOOL (114)	273
HIGH SCHOOL (118)	273
HIGH SCHOOL (119)	273
HIGH SCHOOL (121)	279.5
REHEARSAL (124)	637.26
MUSIC STORAGE (120)	176.04
WORSHIP (103)	6247.5
STAGE (104)	1078.73
JANITOR (117)	85.75
STORAGE (147)	264.6
STORAGE (141)	127.5
BAPTISMAL (127)	82.67
STORAGE (250)	230.11
CHILDREN (247)	406.25
CHILDREN (248)	414.81
CHILDREN (245)	433.88
CHILDREN (240)	433.88
CHILDREN (241)	388.5
CHILD CHURCH (238)	419.25
STORAGE (239)	175.56
CHILD CHURCH (237)	411.125
CHILD CHURCH (236)	390
JANITORS (233)	102.22
CHILD CHURCH (234)	311.67
WORK ROOM (227)	152.77
FIN. SEC. OFFICE (225)	191.17
Y. PASTOR OFFICE (224)	191.17
W. PASTOR OFFICE (223)	191.17
L PASTOR OFFICE (222)	191.17
S PASTOR OFFICE (221)	287.32
CHAPEL (228)	462
ADULT (218)	388.41
ADULT (217)	233.7
ADULT (215)	225.48
ADULT (213)	225.48
ADULT (211)	225.48
ADULT (210)	272.17
ADULT (207)	267.73
COFFEE (208)	144.62
STORAGE (209)	142.1875
ADULT (205)	272.1
ADULT (204)	303.31
ADULT (203)	268.78
ADULT (201)	305.06
TODDLERS	480
TOTAL	26438.4175

PAGE	NAME
1	COVER SHEET
2	INTRODUCTION
3-4	PROGRAM REQUIREMENTS
5	PROGRAM LAYOUT
6-7	SURVEY RESULTS
8	RECEPTION / ADMIN
9	NURSE
10	COUNSELOR
11	SPEECH SERVICES
12	BOARD OFFICE
13	HEAD OF SCHOOL
14	CURRICULUM COORDINATOR
15	STAFF LOUNGE
16	CONFERENCE ROOM
17	MAINTENANCE
18	LIBRARY
19	BOOK STORAGE
20	MATH AND READING SPECIALIST
21	CR FOR INTERVENTION / TESTING
22	CR FOR STEM / COMPUTER LB
23	KINDERGARTEN
24	1ST GRADE
25	2ND GRADE
26	3RD GRADE
27	4TH GRADE
28	ART
29	LATIN
30	SPANISH
31	SPECIAL EDUCATION
32	5TH / 6TH GRADE SCIENCE
33	5TH / 6TH GRADE ENGLISH
34	5TH / 6TH GRADE MATHEMATICS
35	5TH / 6TH GRADE HISTORY
36	7TH / 8TH GRADE SCIENCE
37	7TH / 8TH GRADE ENGLISH
38	7TH / 8TH GRADE HISTORY
39	7TH / 8TH GRADE MATHEMATICS
40	GYM
41	PE OFFICE
42	BAND
43	MUSIC
44	CAFETERIA
45	ADJACENCIES
46	CONCEPTUAL FLOOR PLANS

Program Layout:

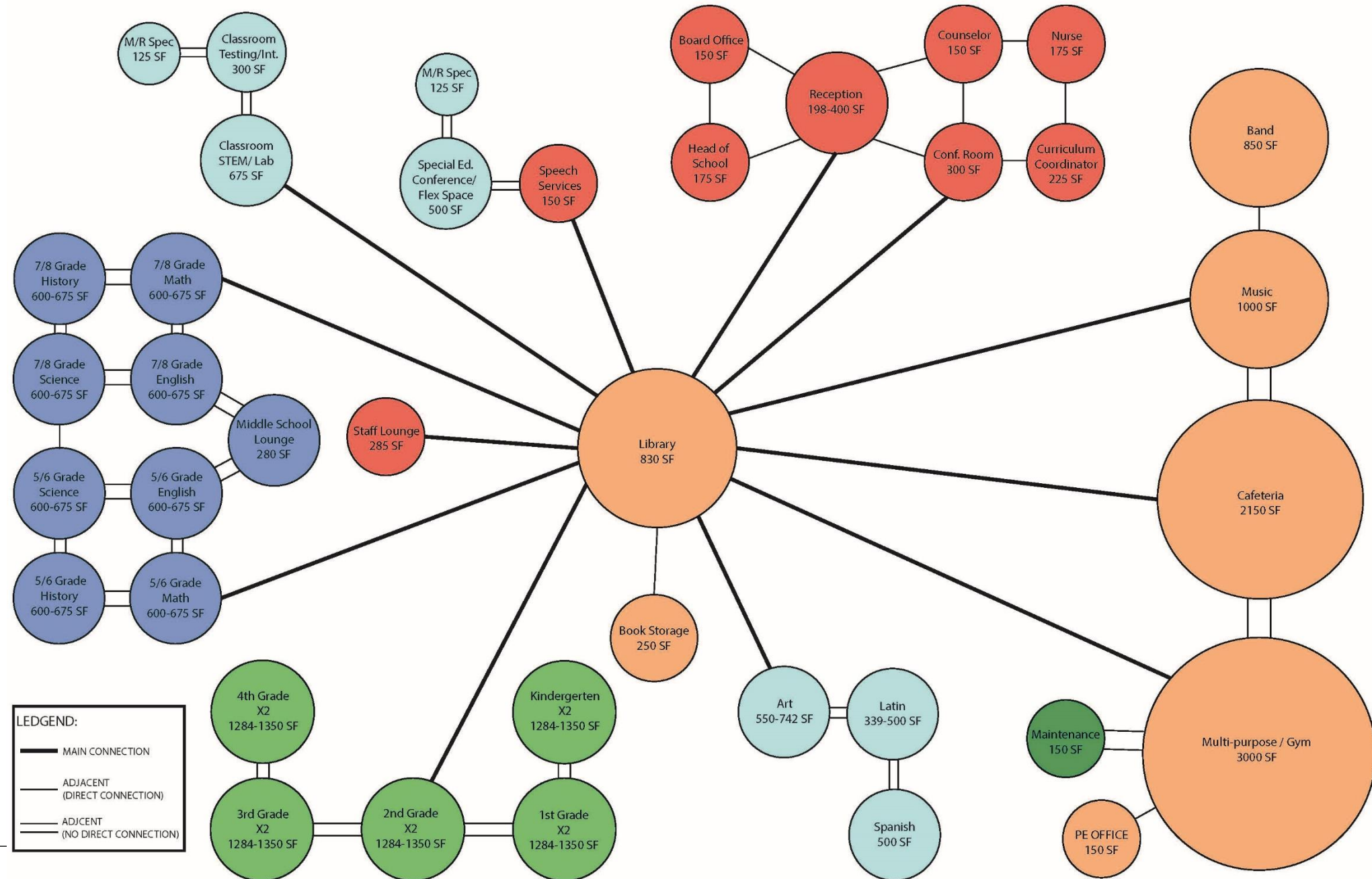

PAGE	NAME
1	COVER SHEET
2	INTRODUCTION
3-4	PROGRAM REQUIREMENTS
5	PROGRAM LAYOUT
6-7	SURVEY RESULTS
8	RECEPTION / ADMIN
9	NURSE
10	COUNSELOR
11	SPEECH SERVICES
12	BOARD OFFICE
13	HEAD OF SCHOOL
14	CURRICULUM COORDINATOR
15	STAFF LOUNGE
16	CONFERENCE ROOM
17	MAINTENANCE
18	LIBRARY
19	BOOK STORAGE
20	MATH AND READING SPECIALIST
21	CR FOR INTERVENTION / TESTING
22	CR FOR STEM / COMPUTER LB
23	KINDERGARTEN
24	1ST GRADE
25	2ND GRADE
26	3RD GRADE
27	4TH GRADE
28	ART
29	LATIN
30	SPANISH
31	SPECIAL EDUCATION
32	5TH / 6TH GRADE SCIENCE
33	5TH / 6TH GRADE ENGLISH
34	5TH / 6TH GRADE MATHEMATICS
35	5TH / 6TH GRADE HISTORY
36	7TH / 8TH GRADE SCIENCE
37	7TH / 8TH GRADE ENGLISH
38	7TH / 8TH GRADE HISTORY
39	7TH / 8TH GRADE MATHEMATICS
40	GYM
41	PE OFFICE
42	BAND
43	MUSIC
44	CAFETERIA
45	ADJACENCIES
46	CONCEPTUAL FLOOR PLANS



323 W. Patrick Street
 Frederick, MD 21701
 (P) 301.698.0020
www.za-d.com



Survey Results Summarized:

VISION

What Makes FCCS Unique?

- The unique curriculum with specialized teaching methods.
- We are a small school allowing for a close community.
- We have friendly staff and a emphasis on core values and acceptance of others
- The students are taught to become lifelong learners within a diverse environment.

How is FCCS perceived by others?

- Known for its specialized and unique teaching method and curriculum
- Desirable alternative instead of public school
- Quality education throughout all grade levels
- Sticks to tradition with a focus on history
- We have a high level of educational expectations with welcoming educational methods

FUNCTIONAL GOALS

How Should the School be Organized?

- The school should include the amenities any professional school has
- The grouping of grades will allow for more focus on the classroom
- Rooms should be organized based on activities in and around the room
- Hallways should include activities
- The library is very important for our student's education

What Adjacencies Should be Pursued?

- The importance of ample space for travel in and around the school is important
- Noisy classrooms (GYM and Band) must be separated from quieter classrooms.
- It is important to have grades grouped together with doors close by so that teachers can communicate plans easier.
- Noise is important, each classroom should have their own experience... not someone else's.

PAGE	NAME
1	COVER SHEET
2	INTRODUCTION
3-4	PROGRAM REQUIREMENTS
5	PROGRAM LAYOUT
6-7	SURVEY RESULTS
8	RECEPTION / ADMIN
9	NURSE
10	COUNSELOR
11	SPEECH SERVICES
12	BOARD OFFICE
13	HEAD OF SCHOOL
14	CURRICULUM COORDINATOR
15	STAFF LOUNGE
16	CONFERENCE ROOM
17	MAINTENANCE
18	LIBRARY
19	BOOK STORAGE
20	MATH AND READING SPECIALIST
21	CR FOR INTERVENTION / TESTING
22	CR FOR STEM / COMPUTER LB
23	KINDERGARTEN
24	1ST GRADE
25	2ND GRADE
26	3RD GRADE
27	4TH GRADE
28	ART
29	LATIN
30	SPANISH
31	SPECIAL EDUCATION
32	5TH / 6TH GRADE SCIENCE
33	5TH / 6TH GRADE ENGLISH
34	5TH / 6TH GRADE MATHEMATICS
35	5TH / 6TH GRADE HISTORY
36	7TH / 8TH GRADE SCIENCE
37	7TH / 8TH GRADE ENGLISH
38	7TH / 8TH GRADE HISTORY
39	7TH / 8TH GRADE MATHEMATICS
40	GYM
41	PE OFFICE
42	BAND
43	MUSIC
44	CAFETERIA
45	ADJACENCIES
46	CONCEPTUAL FLOOR PLANS



323 W. Patrick Street
 Frederick, MD 21701
 (P) 301.698.0020
www.za-d.com



What Should the Approach be to Security vs Accessibility at the new School?

- o The security of the building needs to be in line if not better than any other school
- o There should only be a few entrances with the main one being the reception
- o Students with disabilities must be able to participate in all activities
- o The school should be all one building to limit entering and leaving the school
- o There should be cameras that can see each part of the school
- o FCPS policies should be implemented
- o Auto lock exterior doors should be implemented in all but the main doors

AESTHETIC GOALS

How should the physical design of the school support the emotional wellbeing of the students and teachers

- o The school should be beautiful and represent a safe place
- o Big classrooms with large windows are important to good education
- o Painted walls to help students always know where they are. Hallways could also be deigned and themed
- o Larger and cleaner spaces allow for the mind to be creative

How should the exterior reflect the unique teaching environment?

- o It should reflect the warmth and wellness shared by all the families involved in the school
- o It should be welcoming with lots of greenery
- o There should be good representation of the school, including large signs so people know they have made it.
- o Classical education is the target so the aesthetic of that should flow throughout the building
- o Classical architecture should be the main idea.

ENVIRONMENTAL/SUSTAINABILITY GOALS

What level of Sustainability should be the goal?

- o Being green is controversial based on answers
- o Being green is great and having it in a school will teach kids about problems earlier
- o The least amount of green we can do without negative effects.
- o Sustainable materials should be used
- o Sensor lights would be helpful but it's also important to teach kids when to turn lights on and off

PAGE	NAME
1	COVER SHEET
2	INTRODUCTION
3-4	PROGRAM REQUIREMENTS
5	PROGRAM LAYOUT
6-7	SURVEY RESULTS
8	RECEPTION / ADMIN
9	NURSE
10	COUNSELOR
11	SPEECH SERVICES
12	BOARD OFFICE
13	HEAD OF SCHOOL
14	CURRICULUM COORDINATOR
15	STAFF LOUNGE
16	CONFERENCE ROOM
17	MAINTENANCE
18	LIBRARY
19	BOOK STORAGE
20	MATH AND READING SPECIALIST
21	CR FOR INTERVENTION / TESTING
22	CR FOR STEM / COMPUTER LB
23	KINDERGARTEN
24	1ST GRADE
25	2ND GRADE
26	3RD GRADE
27	4TH GRADE
28	ART
29	LATIN
30	SPANISH
31	SPECIAL EDUCATION
32	5TH / 6TH GRADE SCIENCE
33	5TH / 6TH GRADE ENGLISH
34	5TH / 6TH GRADE MATHEMATICS
35	5TH / 6TH GRADE HISTORY
36	7TH / 8TH GRADE SCIENCE
37	7TH / 8TH GRADE ENGLISH
38	7TH / 8TH GRADE HISTORY
39	7TH / 8TH GRADE MATHEMATICS
40	GYM
41	PE OFFICE
42	BAND
43	MUSIC
44	CAFETERIA
45	ADJACENCIES
46	CONCEPTUAL FLOOR PLANS



323 W. Patrick Street
 Frederick, MD 21701
 (P) 301.698.0020
www.za-d.com



Building Breakdown by Room:

Room Name	Reception/ Admin Assistant
Area Type	Front Office
Description	The reception acts as the main entrance to the school. The reception should act as a gateway for students to enter classes and for staff to get to their offices.
Room SF	300
Room Count	1
Adjacency Requirements	-Must be located directly next to front entrance -This room should be directly connected to all Offices and rooms tagged as "Front Office"
Security Requirements	-Doors must have the ability to lock -Alarm control will be here for the event of an emergency
Privacy Requirements	N/A
Furnishing and Equipment	-The office will also include desks for the admin assistant as well as the front desk (Reception desk) -As the entrance it is important for there to be an attendance set up. Here will be where late slips and absences will be worked with
Lighting Requirements	The room must be well-lit.
Electrical Requirements	Per Code
Mechanical Requirements	N/A
Special Requirements / Orientation	N/A

PAGE	NAME
1	COVER SHEET
2	INTRODUCTION
3-4	PROGRAM REQUIREMENTS
5	PROGRAM LAYOUT
6-7	SURVEY RESULTS
8	RECEPTION / ADMIN
9	NURSE
10	COUNSELOR
11	SPEECH SERVICES
12	BOARD OFFICE
13	HEAD OF SCHOOL
14	CURRICULUM COORDINATOR
15	STAFF LOUNGE
16	CONFERENCE ROOM
17	MAINTENANCE
18	LIBRARY
19	BOOK STORAGE
20	MATH AND READING SPECIALIST
21	CR FOR INTERVENTION / TESTING
22	CR FOR STEM / COMPUTER LB
23	KINDERGARTEN
24	1ST GRADE
25	2ND GRADE
26	3RD GRADE
27	4TH GRADE
28	ART
29	LATIN
30	SPANISH
31	SPECIAL EDUCATION
32	5TH / 6TH GRADE SCIENCE
33	5TH / 6TH GRADE ENGLISH
34	5TH / 6TH GRADE MATHEMATICS
35	5TH / 6TH GRADE HISTORY
36	7TH / 8TH GRADE SCIENCE
37	7TH / 8TH GRADE ENGLISH
38	7TH / 8TH GRADE HISTORY
39	7TH / 8TH GRADE MATHEMATICS
40	GYM
41	PE OFFICE
42	BAND
43	MUSIC
44	CAFETERIA
45	ADJACENCIES
46	CONCEPTUAL FLOOR PLANS



323 W. Patrick Street
 Frederick, MD 21701
 (P) 301.698.0020
www.za-d.com



Room Name	Nurse
Area Type	Front Office
Description	The nurse's office should be the cleanest area of the school that students and teachers can go to receive treatment for any illness or injury sustained throughout the school day.
Room SF	175
Room Count	1
Adjacency Requirements	-This room should be directly connected to all Offices and rooms tagged as "Front Office" -Should be easily accessible from all parts of the school.
Security Requirements	N/A
Privacy Requirements	N/A
Furnishing and Equipment	-The nurse needs to be the cleanest area in the school so there will be amenities included in the room to keep it clean. -There will also be a bathroom in the nurse's office for occasional use -Sinks will be important to help keep the room and the students in good hygiene -The nurse office will also be equipped with storage for all of the nurses needs
Lighting Requirements	Lighting must be sufficient enough for the nurse to see every detail of what she is doing
Electrical Requirements	Per Code
Mechanical Requirements	N/A
Special Requirements / Orientation	N/A

PAGE	NAME
1	COVER SHEET
2	INTRODUCTION
3-4	PROGRAM REQUIREMENTS
5	PROGRAM LAYOUT
6-7	SURVEY RESULTS
8	RECEPTION / ADMIN
9	NURSE
10	COUNSELOR
11	SPEECH SERVICES
12	BOARD OFFICE
13	HEAD OF SCHOOL
14	CURRICULUM COORDINATOR
15	STAFF LOUNGE
16	CONFERENCE ROOM
17	MAINTENANCE
18	LIBRARY
19	BOOK STORAGE
20	MATH AND READING SPECIALIST
21	CR FOR INTERVENTION / TESTING
22	CR FOR STEM / COMPUTER LB
23	KINDERGARTEN
24	1ST GRADE
25	2ND GRADE
26	3RD GRADE
27	4TH GRADE
28	ART
29	LATIN
30	SPANISH
31	SPECIAL EDUCATION
32	5TH / 6TH GRADE SCIENCE
33	5TH / 6TH GRADE ENGLISH
34	5TH / 6TH GRADE MATHEMATICS
35	5TH / 6TH GRADE HISTORY
36	7TH / 8TH GRADE SCIENCE
37	7TH / 8TH GRADE ENGLISH
38	7TH / 8TH GRADE HISTORY
39	7TH / 8TH GRADE MATHEMATICS
40	GYM
41	PE OFFICE
42	BAND
43	MUSIC
44	CAFETERIA
45	ADJACENCIES
46	CONCEPTUAL FLOOR PLANS



323 W. Patrick Street
 Frederick, MD 21701
 (P) 301.698.0020
www.za-d.com



Room Name	Counselor / Focus room suite w/ waiting area
Area Type	Front Office
Description	The Student Counselor will spend most of their day here whether working with files or meeting with students.
Room SF	150
Room Count	1
Adjacency Requirements	This room should be directly connected to all Offices and rooms tagged as "Front Office"
Security Requirements	This room must have Lockable Doors.
Privacy Requirements	They will have privacy to complete any task they might need. They will also be provided ample amount of furniture to hold meetings within the office
Furnishing and Equipment	-Basic Furniture Must be included in this office for the comfort of the Counselor and their visitors. -A computer, Desk, and intercom / Phone will be included in this office for work purposes
Lighting Requirements	The room must be well-lit.
Electrical Requirements	Per Code
Mechanical Requirements	N/A
Special Requirements / Orientation	N/A

PAGE	NAME
1	COVER SHEET
2	INTRODUCTION
3-4	PROGRAM REQUIREMENTS
5	PROGRAM LAYOUT
6-7	SURVEY RESULTS
8	RECEPTION / ADMIN
9	NURSE
10	COUNSELOR
11	SPEECH SERVICES
12	BOARD OFFICE
13	HEAD OF SCHOOL
14	CURRICULUM COORDINATOR
15	STAFF LOUNGE
16	CONFERENCE ROOM
17	MAINTENANCE
18	LIBRARY
19	BOOK STORAGE
20	MATH AND READING SPECIALIST
21	CR FOR INTERVENTION / TESTING
22	CR FOR STEM / COMPUTER LB
23	KINDERGARTEN
24	1ST GRADE
25	2ND GRADE
26	3RD GRADE
27	4TH GRADE
28	ART
29	LATIN
30	SPANISH
31	SPECIAL EDUCATION
32	5TH / 6TH GRADE SCIENCE
33	5TH / 6TH GRADE ENGLISH
34	5TH / 6TH GRADE MATHEMATICS
35	5TH / 6TH GRADE HISTORY
36	7TH / 8TH GRADE SCIENCE
37	7TH / 8TH GRADE ENGLISH
38	7TH / 8TH GRADE HISTORY
39	7TH / 8TH GRADE MATHEMATICS
40	GYM
41	PE OFFICE
42	BAND
43	MUSIC
44	CAFETERIA
45	ADJACENCIES
46	CONCEPTUAL FLOOR PLANS



323 W. Patrick Street
 Frederick, MD 21701
 (P) 301.698.0020
www.za-d.com



Room Name	Speech Services
Area Type	Front Office
Description	This room will be used to work with students to develop their speaking skills.
Room SF	150
Room Count	1
Adjacency Requirements	This room should be directly connected to all Offices and rooms tagged as "Front Office"
Security Requirements	This room must have lockable doors.
Privacy Requirements	They will have privacy to complete any task they might need. They will also be provided ample amount of furniture to hold meetings within the office
Furnishing and Equipment	-Basic Furniture Must be included in this office for the comfort of the Counselor and their visitors. -A computer, Desk, and intercom / Phone will be included in this office for work purposes -The speech room should have a mirror mounted on the wall to supplement vocal skills training -The speech room should also be equipped this a sink and count space
Lighting Requirements	The room must be well-lit.
Electrical Requirements	Per Code
Mechanical Requirements	N/A
Special Requirements / Orientation	N/A

PAGE	NAME
1	COVER SHEET
2	INTRODUCTION
3-4	PROGRAM REQUIREMENTS
5	PROGRAM LAYOUT
6-7	SURVEY RESULTS
8	RECEPTION / ADMIN
9	NURSE
10	COUNSELOR
11	SPEECH SERVICES
12	BOARD OFFICE
13	HEAD OF SCHOOL
14	CURRICULUM COORDINATOR
15	STAFF LOUNGE
16	CONFERENCE ROOM
17	MAINTENANCE
18	LIBRARY
19	BOOK STORAGE
20	MATH AND READING SPECIALIST
21	CR FOR INTERVENTION / TESTING
22	CR FOR STEM / COMPUTER LB
23	KINDERGARTEN
24	1ST GRADE
25	2ND GRADE
26	3RD GRADE
27	4TH GRADE
28	ART
29	LATIN
30	SPANISH
31	SPECIAL EDUCATION
32	5TH / 6TH GRADE SCIENCE
33	5TH / 6TH GRADE ENGLISH
34	5TH / 6TH GRADE MATHEMATICS
35	5TH / 6TH GRADE HISTORY
36	7TH / 8TH GRADE SCIENCE
37	7TH / 8TH GRADE ENGLISH
38	7TH / 8TH GRADE HISTORY
39	7TH / 8TH GRADE MATHEMATICS
40	GYM
41	PE OFFICE
42	BAND
43	MUSIC
44	CAFETERIA
45	ADJACENCIES
46	CONCEPTUAL FLOOR PLANS



323 W. Patrick Street
 Frederick, MD 21701
 (P) 301.698.0020
www.za-d.com



Room Name	Board Office
Area Type	Front Office
Description	The Board office will be used by the board member that's stationed at this school. They will have privacy to complete any task they might need. They will also be provided ample amount of furniture to hold meetings within the office.
Room SF	150
Room Count	1
Adjacency Requirements	This room should be directly connected to all Offices and rooms tagged as "Front Office"
Security Requirements	This room must have lockable doors.
Privacy Requirements	They will have privacy to complete any task they might need. They will also be provided ample amount of furniture to hold meetings within the office
Furnishing and Equipment	-Basic Furniture Must be included in this office for the comfort of the Counselor and their visitors. -A computer, Desk, and intercom / Phone will be included in this office for work purposes
Lighting Requirements	The room must be well-lit.
Electrical Requirements	Per Code
Mechanical Requirements	N/A
Special Requirements / Orientation	N/A

PAGE	NAME
1	COVER SHEET
2	INTRODUCTION
3-4	PROGRAM REQUIREMENTS
5	PROGRAM LAYOUT
6-7	SURVEY RESULTS
8	RECEPTION / ADMIN
9	NURSE
10	COUNSELOR
11	SPEECH SERVICES
12	BOARD OFFICE
13	HEAD OF SCHOOL
14	CURRICULUM COORDINATOR
15	STAFF LOUNGE
16	CONFERENCE ROOM
17	MAINTENANCE
18	LIBRARY
19	BOOK STORAGE
20	MATH AND READING SPECIALIST
21	CR FOR INTERVENTION / TESTING
22	CR FOR STEM / COMPUTER LB
23	KINDERGARTEN
24	1ST GRADE
25	2ND GRADE
26	3RD GRADE
27	4TH GRADE
28	ART
29	LATIN
30	SPANISH
31	SPECIAL EDUCATION
32	5TH / 6TH GRADE SCIENCE
33	5TH / 6TH GRADE ENGLISH
34	5TH / 6TH GRADE MATHEMATICS
35	5TH / 6TH GRADE HISTORY
36	7TH / 8TH GRADE SCIENCE
37	7TH / 8TH GRADE ENGLISH
38	7TH / 8TH GRADE HISTORY
39	7TH / 8TH GRADE MATHEMATICS
40	GYM
41	PE OFFICE
42	BAND
43	MUSIC
44	CAFETERIA
45	ADJACENCIES
46	CONCEPTUAL FLOOR PLANS



323 W. Patrick Street
 Frederick, MD 21701
 (P) 301.698.0020
www.za-d.com



Room Name	Head of School
Area Type	Front Office
Description	The head of school's office will be used by the Principal of the school. They will have privacy to complete any task they might need. They will also be provided ample amount of furniture to hold meetings within the office.
Room SF	175
Room Count	1
Adjacency Requirements	This room should be directly connected to all Offices and rooms tagged as "Front Office"
Security Requirements	This room must have lockable doors.
Privacy Requirements	They will have privacy to complete any task they might need. They will also be provided ample amount of furniture to hold meetings within the office
Furnishing and Equipment	-Basic Furniture Must be included in this office for the comfort of the Counselor and their visitors. -A computer, Desk, and intercom / Phone will be included in this office for work purposes
Lighting Requirements	The room must be well-lit.
Electrical Requirements	Per Code
Mechanical Requirements	N/A
Special Requirements / Orientation	N/A

PAGE	NAME
1	COVER SHEET
2	INTRODUCTION
3-4	PROGRAM REQUIREMENTS
5	PROGRAM LAYOUT
6-7	SURVEY RESULTS
8	RECEPTION / ADMIN
9	NURSE
10	COUNSELOR
11	SPEECH SERVICES
12	BOARD OFFICE
13	HEAD OF SCHOOL
14	CURRICULUM COORDINATOR
15	STAFF LOUNGE
16	CONFERENCE ROOM
17	MAINTENANCE
18	LIBRARY
19	BOOK STORAGE
20	MATH AND READING SPECIALIST
21	CR FOR INTERVENTION / TESTING
22	CR FOR STEM / COMPUTER LB
23	KINDERGARTEN
24	1ST GRADE
25	2ND GRADE
26	3RD GRADE
27	4TH GRADE
28	ART
29	LATIN
30	SPANISH
31	SPECIAL EDUCATION
32	5TH / 6TH GRADE SCIENCE
33	5TH / 6TH GRADE ENGLISH
34	5TH / 6TH GRADE MATHEMATICS
35	5TH / 6TH GRADE HISTORY
36	7TH / 8TH GRADE SCIENCE
37	7TH / 8TH GRADE ENGLISH
38	7TH / 8TH GRADE HISTORY
39	7TH / 8TH GRADE MATHEMATICS
40	GYM
41	PE OFFICE
42	BAND
43	MUSIC
44	CAFETERIA
45	ADJACENCIES
46	CONCEPTUAL FLOOR PLANS



323 W. Patrick Street
 Frederick, MD 21701
 (P) 301.698.0020
www.za-d.com



Room Name Curriculum Coordinator

Area Type	Front Office
Description	This office will be used by the Curriculum coordinator that's stationed at this school. They will have privacy to complete any task they might need. They will also be provided ample amount of furniture to hold meetings within the office.
Room SF	225
Room Count	1
Adjacency Requirements	This room should be directly connected to all Offices and rooms tagged as "Front Office"
Security Requirements	This room must have lockable doors.
Privacy Requirements	They will have privacy to complete any task they might need. They will also be provided ample amount of furniture to hold meetings within the office
Furnishing and Equipment	-Basic Furniture Must be included in this office for the comfort of the Counselor and their visitors. -A computer, Desk, and intercom / Phone will be included in this office for work purposes
Lighting Requirements	The room must be well-lit.
Electrical Requirements	Per Code
Mechanical Requirements	N/A
Special Requirements / Orientation	N/A

PAGE	NAME
1	COVER SHEET
2	INTRODUCTION
3-4	PROGRAM REQUIREMENTS
5	PROGRAM LAYOUT
6-7	SURVEY RESULTS
8	RECEPTION / ADMIN
9	NURSE
10	COUNSELOR
11	SPEECH SERVICES
12	BOARD OFFICE
13	HEAD OF SCHOOL
14	CURRICULUM COORDINATOR
15	STAFF LOUNGE
16	CONFERENCE ROOM
17	MAINTENANCE
18	LIBRARY
19	BOOK STORAGE
20	MATH AND READING SPECIALIST
21	CR FOR INTERVENTION / TESTING
22	CR FOR STEM / COMPUTER LB
23	KINDERGARTEN
24	1ST GRADE
25	2ND GRADE
26	3RD GRADE
27	4TH GRADE
28	ART
29	LATIN
30	SPANISH
31	SPECIAL EDUCATION
32	5TH / 6TH GRADE SCIENCE
33	5TH / 6TH GRADE ENGLISH
34	5TH / 6TH GRADE MATHEMATICS
35	5TH / 6TH GRADE HISTORY
36	7TH / 8TH GRADE SCIENCE
37	7TH / 8TH GRADE ENGLISH
38	7TH / 8TH GRADE HISTORY
39	7TH / 8TH GRADE MATHEMATICS
40	GYM
41	PE OFFICE
42	BAND
43	MUSIC
44	CAFETERIA
45	ADJACENCIES
46	CONCEPTUAL FLOOR PLANS



323 W. Patrick Street
 Frederick, MD 21701
 (P) 301.698.0020
www.za-d.com



Room Name	Staff Lounge
Area Type	Staff
Description	The staff lounge will provide a place of relaxation for all staff members. They are welcome during any portion of the day but it is set up in a way that will allow teachers to come here during lunch hours to eat and chat with fellow colleagues.
Room SF	350
Room Count	1
Adjacency Requirements	This room should be directly connected to all Offices and rooms tagged as "Front Office"
Security Requirements	This room will be locked for use only by teachers and staff
Privacy Requirements	This Room Should be hidden away from students so the teachers will have a relaxation space of their own.
Furnishing and Equipment	The staff lounge will include basics for relaxation and lunch. It will include Vending machines, Couches, Tables, counters, and a refrigerator
Lighting Requirements	The room must be well-lit.
Electrical Requirements	Per Code
Mechanical Requirements	N/A
Special Requirements / Orientation	N/A

PAGE	NAME
1	COVER SHEET
2	INTRODUCTION
3-4	PROGRAM REQUIREMENTS
5	PROGRAM LAYOUT
6-7	SURVEY RESULTS
8	RECEPTION / ADMIN
9	NURSE
10	COUNSELOR
11	SPEECH SERVICES
12	BOARD OFFICE
13	HEAD OF SCHOOL
14	CURRICULUM COORDINATOR
15	STAFF LOUNGE
16	CONFERENCE ROOM
17	MAINTENANCE
18	LIBRARY
19	BOOK STORAGE
20	MATH AND READING SPECIALIST
21	CR FOR INTERVENTION / TESTING
22	CR FOR STEM / COMPUTER LB
23	KINDERGARTEN
24	1ST GRADE
25	2ND GRADE
26	3RD GRADE
27	4TH GRADE
28	ART
29	LATIN
30	SPANISH
31	SPECIAL EDUCATION
32	5TH / 6TH GRADE SCIENCE
33	5TH / 6TH GRADE ENGLISH
34	5TH / 6TH GRADE MATHEMATICS
35	5TH / 6TH GRADE HISTORY
36	7TH / 8TH GRADE SCIENCE
37	7TH / 8TH GRADE ENGLISH
38	7TH / 8TH GRADE HISTORY
39	7TH / 8TH GRADE MATHEMATICS
40	GYM
41	PE OFFICE
42	BAND
43	MUSIC
44	CAFETERIA
45	ADJACENCIES
46	CONCEPTUAL FLOOR PLANS



323 W. Patrick Street
 Frederick, MD 21701
 (P) 301.698.0020
www.za-d.com



Room Name	Conference Room
Area Type	Staff
Description	The conference room provides a place for meetings and presentations. This room can be used by staff, clubs and any other school related organizations.
Room SF	250
Room Count	1
Adjacency Requirements	This room should be directly connected to all Offices and rooms tagged as "Front Office"
Security Requirements	This room will be locked for use only by teachers or an SPTA
Privacy Requirements	This Room Should be hidden away from students so the teachers will have a relaxation space of their own.
Furnishing and Equipment	The conference room should be used for meeting so it will include a conference table, whiteboard, and promethean board. The boards will provide ease during presentations.
Lighting Requirements	The room must be well-lit.
Electrical Requirements	Per Code
Mechanical Requirements	N/A
Special Requirements / Orientation	N/A

PAGE	NAME
1	COVER SHEET
2	INTRODUCTION
3-4	PROGRAM REQUIREMENTS
5	PROGRAM LAYOUT
6-7	SURVEY RESULTS
8	RECEPTION / ADMIN
9	NURSE
10	COUNSELOR
11	SPEECH SERVICES
12	BOARD OFFICE
13	HEAD OF SCHOOL
14	CURRICULUM COORDINATOR
15	STAFF LOUNGE
16	CONFERENCE ROOM
17	MAINTENANCE
18	LIBRARY
19	BOOK STORAGE
20	MATH AND READING SPECIALIST
21	CR FOR INTERVENTION / TESTING
22	CR FOR STEM / COMPUTER LB
23	KINDERGARTEN
24	1ST GRADE
25	2ND GRADE
26	3RD GRADE
27	4TH GRADE
28	ART
29	LATIN
30	SPANISH
31	SPECIAL EDUCATION
32	5TH / 6TH GRADE SCIENCE
33	5TH / 6TH GRADE ENGLISH
34	5TH / 6TH GRADE MATHEMATICS
35	5TH / 6TH GRADE HISTORY
36	7TH / 8TH GRADE SCIENCE
37	7TH / 8TH GRADE ENGLISH
38	7TH / 8TH GRADE HISTORY
39	7TH / 8TH GRADE MATHEMATICS
40	GYM
41	PE OFFICE
42	BAND
43	MUSIC
44	CAFETERIA
45	ADJACENCIES
46	CONCEPTUAL FLOOR PLANS



323 W. Patrick Street
 Frederick, MD 21701
 (P) 301.698.0020
www.za-d.com



Room Name Maintenance and Server Room

Area Type	Staff
Description	This room provides some storage for maintenance equipment but mainly holds mechanical equipment that will be used to run the building.
Room SF	150
Room Count	1
Adjacency Requirements	This room should be located in a louder part of the school so if maintenance needs to be done it doesn't distract from everyday activities
Security Requirements	This room will be locked for use only by staff.
Privacy Requirements	This Room Should be hidden away from the typical day to day activities.
Furnishing and Equipment	N/A
Lighting Requirements	The room must be well-lit for future maintenance work.
Electrical Requirements	Per Code
Mechanical Requirements	Mechanical Equipment
Special Requirements / Orientation	N/A

PAGE	NAME
1	COVER SHEET
2	INTRODUCTION
3-4	PROGRAM REQUIREMENTS
5	PROGRAM LAYOUT
6-7	SURVEY RESULTS
8	RECEPTION / ADMIN
9	NURSE
10	COUNSELOR
11	SPEECH SERVICES
12	BOARD OFFICE
13	HEAD OF SCHOOL
14	CURRICULUM COORDINATOR
15	STAFF LOUNGE
16	CONFERENCE ROOM
17	MAINTENANCE
18	LIBRARY
19	BOOK STORAGE
20	MATH AND READING SPECIALIST
21	CR FOR INTERVENTION / TESTING
22	CR FOR STEM / COMPUTER LB
23	KINDERGARTEN
24	1ST GRADE
25	2ND GRADE
26	3RD GRADE
27	4TH GRADE
28	ART
29	LATIN
30	SPANISH
31	SPECIAL EDUCATION
32	5TH / 6TH GRADE SCIENCE
33	5TH / 6TH GRADE ENGLISH
34	5TH / 6TH GRADE MATHEMATICS
35	5TH / 6TH GRADE HISTORY
36	7TH / 8TH GRADE SCIENCE
37	7TH / 8TH GRADE ENGLISH
38	7TH / 8TH GRADE HISTORY
39	7TH / 8TH GRADE MATHEMATICS
40	GYM
41	PE OFFICE
42	BAND
43	MUSIC
44	CAFETERIA
45	ADJACENCIES
46	CONCEPTUAL FLOOR PLANS



323 W. Patrick Street
 Frederick, MD 21701
 (P) 301.698.0020
www.za-d.com



Room Name	Library
Area Type	Communal
Description	The library is the hub of the school. The library will be used universally as a place for students and teachers to research. The library is filled with books that can be checked out by families that belong to the school.
Room SF	830
Room Count	1
Adjacency Requirements	-The library shall be centralized as it is important for and learning circumstance -This room should be easily reached by anywhere in the school
Security Requirements	-The Library should have lockable doors. -Security Cameras will be in use in this room
Privacy Requirements	N/A
Furnishing and Equipment	-For a successful library we have included computers and a checkout desk for ease of book renting. -A projector and promethean board have also been included for situations where classes or presentations are being held in the library. -Bookshelves should be very prominent and laid out in a way that makes searching for books easy.
Lighting Requirements	Natural light is important in this room to help create a better learning environment.
Electrical Requirements	Per Code
Mechanical Requirements	N/A
Special Requirements / Orientation	N/A

PAGE	NAME
1	COVER SHEET
2	INTRODUCTION
3-4	PROGRAM REQUIREMENTS
5	PROGRAM LAYOUT
6-7	SURVEY RESULTS
8	RECEPTION / ADMIN
9	NURSE
10	COUNSELOR
11	SPEECH SERVICES
12	BOARD OFFICE
13	HEAD OF SCHOOL
14	CURRICULUM COORDINATOR
15	STAFF LOUNGE
16	CONFERENCE ROOM
17	MAINTENANCE
18	LIBRARY
19	BOOK STORAGE
20	MATH AND READING SPECIALIST
21	CR FOR INTERVENTION / TESTING
22	CR FOR STEM / COMPUTER LB
23	KINDERGARTEN
24	1ST GRADE
25	2ND GRADE
26	3RD GRADE
27	4TH GRADE
28	ART
29	LATIN
30	SPANISH
31	SPECIAL EDUCATION
32	5TH / 6TH GRADE SCIENCE
33	5TH / 6TH GRADE ENGLISH
34	5TH / 6TH GRADE MATHEMATICS
35	5TH / 6TH GRADE HISTORY
36	7TH / 8TH GRADE SCIENCE
37	7TH / 8TH GRADE ENGLISH
38	7TH / 8TH GRADE HISTORY
39	7TH / 8TH GRADE MATHEMATICS
40	GYM
41	PE OFFICE
42	BAND
43	MUSIC
44	CAFETERIA
45	ADJACENCIES
46	CONCEPTUAL FLOOR PLANS



323 W. Patrick Street
 Frederick, MD 21701
 (P) 301.698.0020
www.za-d.com



Room Name	Book Storage
Area Type	Staff
Description	Overflow books and book recently checked back in will be stored here until available space opens for them in the library. There will also be stored textbooks here for each of the classrooms.
Room SF	250
Room Count	1
Adjacency Requirements	This room needs to be directly connected to the library
Security Requirements	This room must have lockable doors only openable by the librarian and teachers.
Privacy Requirements	N/A
Furnishing and Equipment	Bookshelves will fill up most of this room as it will act as a storage room.
Lighting Requirements	The room should be lit with enough light to find books.
Electrical Requirements	Per Code
Mechanical Requirements	N/A
Special Requirements / Orientation	N/A

PAGE	NAME
1	COVER SHEET
2	INTRODUCTION
3-4	PROGRAM REQUIREMENTS
5	PROGRAM LAYOUT
6-7	SURVEY RESULTS
8	RECEPTION / ADMIN
9	NURSE
10	COUNSELOR
11	SPEECH SERVICES
12	BOARD OFFICE
13	HEAD OF SCHOOL
14	CURRICULUM COORDINATOR
15	STAFF LOUNGE
16	CONFERENCE ROOM
17	MAINTENANCE
18	LIBRARY
19	BOOK STORAGE
20	MATH AND READING SPECIALIST
21	CR FOR INTERVENTION / TESTING
22	CR FOR STEM / COMPUTER LB
23	KINDERGARTEN
24	1ST GRADE
25	2ND GRADE
26	3RD GRADE
27	4TH GRADE
28	ART
29	LATIN
30	SPANISH
31	SPECIAL EDUCATION
32	5TH / 6TH GRADE SCIENCE
33	5TH / 6TH GRADE ENGLISH
34	5TH / 6TH GRADE MATHEMATICS
35	5TH / 6TH GRADE HISTORY
36	7TH / 8TH GRADE SCIENCE
37	7TH / 8TH GRADE ENGLISH
38	7TH / 8TH GRADE HISTORY
39	7TH / 8TH GRADE MATHEMATICS
40	GYM
41	PE OFFICE
42	BAND
43	MUSIC
44	CAFETERIA
45	ADJACENCIES
46	CONCEPTUAL FLOOR PLANS



323 W. Patrick Street
 Frederick, MD 21701
 (P) 301.698.0020
www.za-d.com



Room Name	Math and Reading Specialist
Area Type	Support
Description	This room will be used for specialized help. Students who require more help in math and English will be brought here for a more in depth look into the topic. We will explore different ways for students to learn so that each student receives the best education possible.
Room SF	255
Room Count	2
Adjacency Requirements	-This room should be farther away from the noise areas in the school (Gym, Music, and Cafeteria). -This room should be easily reached by age-based classrooms as they will be pulling students here from all of the grades
Security Requirements	This room must have lockable doors. Lockable Storage will be provided for teachers
Privacy Requirements	Door window covers should be provided for the event of a security breach or ease of distraction.
Furnishing and Equipment	-This room requires a whiteboard, desks, lockable teacher storage, and open shelving for students supplies. -Computers will be supplied for research and special needs -Locked Storage will be supplied for teachers
Lighting Requirements	The room must be well-lit with a lot of natural light.
Electrical Requirements	Per Code
Mechanical Requirements	N/A
Special Requirements / Orientation	N/A

PAGE	NAME
1	COVER SHEET
2	INTRODUCTION
3-4	PROGRAM REQUIREMENTS
5	PROGRAM LAYOUT
6-7	SURVEY RESULTS
8	RECEPTION / ADMIN
9	NURSE
10	COUNSELOR
11	SPEECH SERVICES
12	BOARD OFFICE
13	HEAD OF SCHOOL
14	CURRICULUM COORDINATOR
15	STAFF LOUNGE
16	CONFERENCE ROOM
17	MAINTENANCE
18	LIBRARY
19	BOOK STORAGE
20	MATH AND READING SPECIALIST
21	CR FOR INTERVENTION / TESTING
22	CR FOR STEM / COMPUTER LB
23	KINDERGARTEN
24	1ST GRADE
25	2ND GRADE
26	3RD GRADE
27	4TH GRADE
28	ART
29	LATIN
30	SPANISH
31	SPECIAL EDUCATION
32	5TH / 6TH GRADE SCIENCE
33	5TH / 6TH GRADE ENGLISH
34	5TH / 6TH GRADE MATHEMATICS
35	5TH / 6TH GRADE HISTORY
36	7TH / 8TH GRADE SCIENCE
37	7TH / 8TH GRADE ENGLISH
38	7TH / 8TH GRADE HISTORY
39	7TH / 8TH GRADE MATHEMATICS
40	GYM
41	PE OFFICE
42	BAND
43	MUSIC
44	CAFETERIA
45	ADJACENCIES
46	CONCEPTUAL FLOOR PLANS



323 W. Patrick Street
 Frederick, MD 21701
 (P) 301.698.0020
www.za-d.com



Room Name Secondary Classroom for Intervention and Testing

Area Type Classroom

Description This new classroom will be used for scheduled testing. Larger tests that require a quieter room will be held in this room.

Room SF 300

Room Count 1

Adjacency Requirements This room should be farther away from the noise areas in the school (Gym, Music, and Cafeteria). As it can be used for testing.

Security Requirements
 -This room must have lockable doors.
 -Lockable Storage will be provided for teachers

Privacy Requirements Door window covers should be provided for the event of a security breach or ease of distraction.

Furnishing and Equipment
 -Desks shall be provided in the Intervention and testing room to be used for examinations
 -Computers will also be provided in the Intervention/Testing room for special need students that require the use of computers.
 -Promethean boards will be provided in this room for the use of both examination and education

Lighting Requirements This room should include enough light needed for test taking.

Electrical Requirements Per Code

Mechanical Requirements N/A

Special Requirements / Orientation N/A

PAGE	NAME
1	COVER SHEET
2	INTRODUCTION
3-4	PROGRAM REQUIREMENTS
5	PROGRAM LAYOUT
6-7	SURVEY RESULTS
8	RECEPTION / ADMIN
9	NURSE
10	COUNSELOR
11	SPEECH SERVICES
12	BOARD OFFICE
13	HEAD OF SCHOOL
14	CURRICULUM COORDINATOR
15	STAFF LOUNGE
16	CONFERENCE ROOM
17	MAINTENANCE
18	LIBRARY
19	BOOK STORAGE
20	MATH AND READING SPECIALIST
21	CR FOR INTERVENTION / TESTING
22	CR FOR STEM / COMPUTER LB
23	KINDERGARTEN
24	1ST GRADE
25	2ND GRADE
26	3RD GRADE
27	4TH GRADE
28	ART
29	LATIN
30	SPANISH
31	SPECIAL EDUCATION
32	5TH / 6TH GRADE SCIENCE
33	5TH / 6TH GRADE ENGLISH
34	5TH / 6TH GRADE MATHEMATICS
35	5TH / 6TH GRADE HISTORY
36	7TH / 8TH GRADE SCIENCE
37	7TH / 8TH GRADE ENGLISH
38	7TH / 8TH GRADE HISTORY
39	7TH / 8TH GRADE MATHEMATICS
40	GYM
41	PE OFFICE
42	BAND
43	MUSIC
44	CAFETERIA
45	ADJACENCIES
46	CONCEPTUAL FLOOR PLANS



323 W. Patrick Street
 Frederick, MD 21701
 (P) 301.698.0020
www.za-d.com



Room Name Secondary Classroom for STEM / Computer Lab

Area Type Classroom

Description This new classroom will be used for any STEM classes that are being held within the school. The room also acts as a computer lab. Teachers who want to use the computer lab, so their class can do research or specialized assignments, will be able to sign up for time in this room.

Room SF 675

Room Count 1

Adjacency Requirements This room should be farther away from the noise areas in the school (Gym, Music, and Cafeteria). As both can be used for testing. The computer lab can be used for online testing

Security Requirements
 -This room must have lockable doors.
 -Lockable Storage will be provided for teachers

Privacy Requirements Door window covers should be provided for the event of a security breach or ease of distraction.

Furnishing and Equipment Promethean boards will be provided in this room for the use of both examination and education. Enough Computers will be set up for any class to visit this room. The computers will be set up in a way for the teacher to easily view the tasks students are trying to complete.

Lighting Requirements This room should be well-lit.

Electrical Requirements Per Code

Mechanical Requirements N/A

Special Requirements / Orientation N/A

PAGE	NAME
1	COVER SHEET
2	INTRODUCTION
3-4	PROGRAM REQUIREMENTS
5	PROGRAM LAYOUT
6-7	SURVEY RESULTS
8	RECEPTION / ADMIN
9	NURSE
10	COUNSELOR
11	SPEECH SERVICES
12	BOARD OFFICE
13	HEAD OF SCHOOL
14	CURRICULUM COORDINATOR
15	STAFF LOUNGE
16	CONFERENCE ROOM
17	MAINTENANCE
18	LIBRARY
19	BOOK STORAGE
20	MATH AND READING SPECIALIST
21	CR FOR INTERVENTION / TESTING
22	CR FOR STEM / COMPUTER LB
23	KINDERGARTEN
24	1ST GRADE
25	2ND GRADE
26	3RD GRADE
27	4TH GRADE
28	ART
29	LATIN
30	SPANISH
31	SPECIAL EDUCATION
32	5TH / 6TH GRADE SCIENCE
33	5TH / 6TH GRADE ENGLISH
34	5TH / 6TH GRADE MATHEMATICS
35	5TH / 6TH GRADE HISTORY
36	7TH / 8TH GRADE SCIENCE
37	7TH / 8TH GRADE ENGLISH
38	7TH / 8TH GRADE HISTORY
39	7TH / 8TH GRADE MATHEMATICS
40	GYM
41	PE OFFICE
42	BAND
43	MUSIC
44	CAFETERIA
45	ADJACENCIES
46	CONCEPTUAL FLOOR PLANS



323 W. Patrick Street
 Frederick, MD 21701
 (P) 301.698.0020
www.za-d.com



Room Name	Kindergarten Classroom
Area Type	Classroom
Description	These classrooms will specialize in basic kindergartener education. All the kindergarteners will be split into one of these two classes.
Room SF	1350
Room Count	2
Adjacency Requirements	-This room should be farther away from the noise areas in the school (Gym, Music, and Cafeteria). As both can be used for testing. The computer lab can be used for online testing -Age Based Classrooms like this one should be adjacent to classrooms of the same grade. Beyond that the grades should be surrounded by the next closes grade on the younger and older side.
Security Requirements	-This room must have lockable doors. -Lockable Storage will be provided for teachers
Privacy Requirements	Door window covers should be provided for the event of a security breach or ease of distraction.
Furnishing and Equipment	-This room requires a whiteboard, desks, lockable teacher storage, and open shelving for students supplies. -Cubbies will be provided for students to store their lunch and supplies -For younger students in Grades K through 4th an in class sink and bathroom will be provided for emergencies and hygienic use.
Lighting Requirements	The room must be well-lit with a lot of natural light.
Electrical Requirements	Per Code
Mechanical Requirements	N/A
Special Requirements / Orientation	N/A

PAGE	NAME
1	COVER SHEET
2	INTRODUCTION
3-4	PROGRAM REQUIREMENTS
5	PROGRAM LAYOUT
6-7	SURVEY RESULTS
8	RECEPTION / ADMIN
9	NURSE
10	COUNSELOR
11	SPEECH SERVICES
12	BOARD OFFICE
13	HEAD OF SCHOOL
14	CURRICULUM COORDINATOR
15	STAFF LOUNGE
16	CONFERENCE ROOM
17	MAINTENANCE
18	LIBRARY
19	BOOK STORAGE
20	MATH AND READING SPECIALIST
21	CR FOR INTERVENTION / TESTING
22	CR FOR STEM / COMPUTER LB
23	KINDERGARTEN
24	1ST GRADE
25	2ND GRADE
26	3RD GRADE
27	4TH GRADE
28	ART
29	LATIN
30	SPANISH
31	SPECIAL EDUCATION
32	5TH / 6TH GRADE SCIENCE
33	5TH / 6TH GRADE ENGLISH
34	5TH / 6TH GRADE MATHEMATICS
35	5TH / 6TH GRADE HISTORY
36	7TH / 8TH GRADE SCIENCE
37	7TH / 8TH GRADE ENGLISH
38	7TH / 8TH GRADE HISTORY
39	7TH / 8TH GRADE MATHEMATICS
40	GYM
41	PE OFFICE
42	BAND
43	MUSIC
44	CAFETERIA
45	ADJACENCIES
46	CONCEPTUAL FLOOR PLANS



323 W. Patrick Street
 Frederick, MD 21701
 (P) 301.698.0020
www.za-d.com



Room Name 1st Grade Classroom

Area Type Classroom

Description These classrooms will specialize in basic 1st grade education. All the 1st graders will be split into one of these two classes.

Room SF 1350

Room Count 2

Adjacency Requirements -This room should be farther away from the noise areas in the school (Gym, Music, and Cafeteria). As both can be used for testing. The computer lab can be used for online testing
 -Age Based Classrooms like this one should be adjacent to classrooms of the same grade. Beyond that the grades should be surrounded by the next closes grade on the younger and older side.

Security Requirements -This room must have lockable doors.
 -Lockable Storage will be provided for teachers

Privacy Requirements Door window covers should be provided for the event of a security breach or ease of distraction.

Furnishing and Equipment -This room requires a whiteboard, desks, lockable teacher storage, and open shelving for students supplies.
 -Cubbies will be provided for students to store their lunch and supplies
 -For younger students in Grades K through 4th an in class sink and bathroom will be provided for emergencies and hygienic use.

Lighting Requirements The room must be well-lit with a lot of natural light.

Electrical Requirements Per Code

Mechanical Requirements N/A

Special Requirements / Orientation N/A

PAGE	NAME
1	COVER SHEET
2	INTRODUCTION
3-4	PROGRAM REQUIREMENTS
5	PROGRAM LAYOUT
6-7	SURVEY RESULTS
8	RECEPTION / ADMIN
9	NURSE
10	COUNSELOR
11	SPEECH SERVICES
12	BOARD OFFICE
13	HEAD OF SCHOOL
14	CURRICULUM COORDINATOR
15	STAFF LOUNGE
16	CONFERENCE ROOM
17	MAINTENANCE
18	LIBRARY
19	BOOK STORAGE
20	MATH AND READING SPECIALIST
21	CR FOR INTERVENTION / TESTING
22	CR FOR STEM / COMPUTER LB
23	KINDERGARTEN
24	1ST GRADE
25	2ND GRADE
26	3RD GRADE
27	4TH GRADE
28	ART
29	LATIN
30	SPANISH
31	SPECIAL EDUCATION
32	5TH / 6TH GRADE SCIENCE
33	5TH / 6TH GRADE ENGLISH
34	5TH / 6TH GRADE MATHEMATICS
35	5TH / 6TH GRADE HISTORY
36	7TH / 8TH GRADE SCIENCE
37	7TH / 8TH GRADE ENGLISH
38	7TH / 8TH GRADE HISTORY
39	7TH / 8TH GRADE MATHEMATICS
40	GYM
41	PE OFFICE
42	BAND
43	MUSIC
44	CAFETERIA
45	ADJACENCIES
46	CONCEPTUAL FLOOR PLANS



323 W. Patrick Street
 Frederick, MD 21701
 (P) 301.698.0020
www.za-d.com



Room Name 2nd Grade Classroom

Area Type Classroom

Description These classrooms will specialize in basic 2nd grade education. All the 2nd graders will be split into one of these two classes.

Room SF 1350

Room Count 2

Adjacency Requirements
 -This room should be farther away from the noise areas in the school (Gym, Music, and Cafeteria). As both can be used for testing. The computer lab can be used for online testing
 -Age Based Classrooms like this one should be adjacent to classrooms of the same grade. Beyond that the grades should be surrounded by the next closes grade on the younger and older side.

Security Requirements
 -This room must have lockable doors.
 -Lockable Storage will be provided for teachers

Privacy Requirements Door window covers should be provided for the event of a security breach or ease of distraction.

Furnishing and Equipment
 -This room requires a whiteboard, desks, lockable teacher storage, and open shelving for students supplies.
 -Cubbies will be provided for students to store their lunch and supplies
 -For younger students in Grades K through 4th an in class sink and bathroom will be provided for emergencies and hygienic use.
 - The room will also include a projector to be used at the teacher's digression

Lighting Requirements The room must be well-lit with a lot of natural light.

Electrical Requirements Per Code

Mechanical Requirements N/A

Special Requirements / Orientation N/A

PAGE	NAME
1	COVER SHEET
2	INTRODUCTION
3-4	PROGRAM REQUIREMENTS
5	PROGRAM LAYOUT
6-7	SURVEY RESULTS
8	RECEPTION / ADMIN
9	NURSE
10	COUNSELOR
11	SPEECH SERVICES
12	BOARD OFFICE
13	HEAD OF SCHOOL
14	CURRICULUM COORDINATOR
15	STAFF LOUNGE
16	CONFERENCE ROOM
17	MAINTENANCE
18	LIBRARY
19	BOOK STORAGE
20	MATH AND READING SPECIALIST
21	CR FOR INTERVENTION / TESTING
22	CR FOR STEM / COMPUTER LB
23	KINDERGARTEN
24	1ST GRADE
25	2ND GRADE
26	3RD GRADE
27	4TH GRADE
28	ART
29	LATIN
30	SPANISH
31	SPECIAL EDUCATION
32	5TH / 6TH GRADE SCIENCE
33	5TH / 6TH GRADE ENGLISH
34	5TH / 6TH GRADE MATHEMATICS
35	5TH / 6TH GRADE HISTORY
36	7TH / 8TH GRADE SCIENCE
37	7TH / 8TH GRADE ENGLISH
38	7TH / 8TH GRADE HISTORY
39	7TH / 8TH GRADE MATHEMATICS
40	GYM
41	PE OFFICE
42	BAND
43	MUSIC
44	CAFETERIA
45	ADJACENCIES
46	CONCEPTUAL FLOOR PLANS



323 W. Patrick Street
 Frederick, MD 21701
 (P) 301.698.0020
www.za-d.com



Room Name 3rd Grade Classroom

Area Type Classroom

Description These classrooms will specialize in basic 3rd grade education. All the 3rd graders will be split into one of these two classes.

Room SF 1350

Room Count 2

Adjacency Requirements
 -This room should be farther away from the noise areas in the school (Gym, Music, and Cafeteria). As both can be used for testing. The computer lab can be used for online testing
 -Age Based Classrooms like this one should be adjacent to classrooms of the same grade. Beyond that the grades should be surrounded by the next closes grade on the younger and older side.

Security Requirements
 -This room must have lockable doors.
 -Lockable Storage will be provided for teachers

Privacy Requirements Door window covers should be provided for the event of a security breach or ease of distraction.

Furnishing and Equipment
 -This room requires a whiteboard, desks, lockable teacher storage, and open shelving for students supplies.
 -Cubbies will be provided for students to store their lunch and supplies
 -For younger students in Grades K through 4th an in class sink and bathroom will be provided for emergencies and hygienic use.
 - The room will also include a projector to be used at the teacher's digression

Lighting Requirements The room must be well-lit with a lot of natural light.

Electrical Requirements Per Code

Mechanical Requirements N/A

Special Requirements / Orientation N/A

PAGE	NAME
1	COVER SHEET
2	INTRODUCTION
3-4	PROGRAM REQUIREMENTS
5	PROGRAM LAYOUT
6-7	SURVEY RESULTS
8	RECEPTION / ADMIN
9	NURSE
10	COUNSELOR
11	SPEECH SERVICES
12	BOARD OFFICE
13	HEAD OF SCHOOL
14	CURRICULUM COORDINATOR
15	STAFF LOUNGE
16	CONFERENCE ROOM
17	MAINTENANCE
18	LIBRARY
19	BOOK STORAGE
20	MATH AND READING SPECIALIST
21	CR FOR INTERVENTION / TESTING
22	CR FOR STEM / COMPUTER LB
23	KINDERGARTEN
24	1ST GRADE
25	2ND GRADE
26	3RD GRADE
27	4TH GRADE
28	ART
29	LATIN
30	SPANISH
31	SPECIAL EDUCATION
32	5TH / 6TH GRADE SCIENCE
33	5TH / 6TH GRADE ENGLISH
34	5TH / 6TH GRADE MATHEMATICS
35	5TH / 6TH GRADE HISTORY
36	7TH / 8TH GRADE SCIENCE
37	7TH / 8TH GRADE ENGLISH
38	7TH / 8TH GRADE HISTORY
39	7TH / 8TH GRADE MATHEMATICS
40	GYM
41	PE OFFICE
42	BAND
43	MUSIC
44	CAFETERIA
45	ADJACENCIES
46	CONCEPTUAL FLOOR PLANS



323 W. Patrick Street
 Frederick, MD 21701
 (P) 301.698.0020
www.za-d.com



Room Name 4th Grade Classroom

Area Type Classroom

Description These classrooms will specialize in basic 4th grade education. All the 4th graders will be split into one of these two classes.

Room SF 1350

Room Count 2

Adjacency Requirements
 -This room should be farther away from the noise areas in the school (Gym, Music, and Cafeteria). As both can be used for testing. The computer lab can be used for online testing
 -Age Based Classrooms like this one should be adjacent to classrooms of the same grade. Beyond that the grades should be surrounded by the next closes grade on the younger and older side.

Security Requirements
 -This room must have lockable doors.
 -Lockable Storage will be provided for teachers

Privacy Requirements Door window covers should be provided for the event of a security breach or ease of distraction.

Furnishing and Equipment
 -This room requires a whiteboard, desks, lockable teacher storage, and open shelving for students supplies.
 -Cubbies will be provided for students to store their lunch and supplies
 -For younger students in Grades K through 4th an in class sink and bathroom will be provided for emergencies and hygienic use.
 - The room will also include a projector to be used at the teacher's digression

Lighting Requirements The room must be well-lit with a lot of natural light.

Electrical Requirements Per Code

Mechanical Requirements N/A

Special Requirements / Orientation N/A

PAGE	NAME
1	COVER SHEET
2	INTRODUCTION
3-4	PROGRAM REQUIREMENTS
5	PROGRAM LAYOUT
6-7	SURVEY RESULTS
8	RECEPTION / ADMIN
9	NURSE
10	COUNSELOR
11	SPEECH SERVICES
12	BOARD OFFICE
13	HEAD OF SCHOOL
14	CURRICULUM COORDINATOR
15	STAFF LOUNGE
16	CONFERENCE ROOM
17	MAINTENANCE
18	LIBRARY
19	BOOK STORAGE
20	MATH AND READING SPECIALIST
21	CR FOR INTERVENTION / TESTING
22	CR FOR STEM / COMPUTER LB
23	KINDERGARTEN
24	1ST GRADE
25	2ND GRADE
26	3RD GRADE
27	4TH GRADE
28	ART
29	LATIN
30	SPANISH
31	SPECIAL EDUCATION
32	5TH / 6TH GRADE SCIENCE
33	5TH / 6TH GRADE ENGLISH
34	5TH / 6TH GRADE MATHEMATICS
35	5TH / 6TH GRADE HISTORY
36	7TH / 8TH GRADE SCIENCE
37	7TH / 8TH GRADE ENGLISH
38	7TH / 8TH GRADE HISTORY
39	7TH / 8TH GRADE MATHEMATICS
40	GYM
41	PE OFFICE
42	BAND
43	MUSIC
44	CAFETERIA
45	ADJACENCIES
46	CONCEPTUAL FLOOR PLANS



323 W. Patrick Street
 Frederick, MD 21701
 (P) 301.698.0020
www.za-d.com



Room Name	Art Classroom
Area Type	Classroom
Description	The art classroom will be used by students of all age levels. Students will come here to experience different types of art. The room will be equipped with enough tools to experience all types of art, from ceramics to painting.
Room SF	742
Room Count	1
Adjacency Requirements	-Art should be located near the other special classrooms. - Should be easily reachable by all Age based classrooms
Security Requirements	-This room must have lockable doors. -Lockable Storage will be provided for teachers
Privacy Requirements	Door window covers should be provided for the event of a security breach or ease of distraction.
Furnishing and Equipment	-The art classroom should be provided with natural light -Large workshop tables will be provided to allow for different pieces of work -A Large art storage is required for Art supplies as well as students work
Lighting Requirements	The art classroom should be provided with natural light
Electrical Requirements	Per Code
Mechanical Requirements	Utilities such as a kiln will be provided to allow for project finishes
Special Requirements / Orientation	N/A

PAGE	NAME
1	COVER SHEET
2	INTRODUCTION
3-4	PROGRAM REQUIREMENTS
5	PROGRAM LAYOUT
6-7	SURVEY RESULTS
8	RECEPTION / ADMIN
9	NURSE
10	COUNSELOR
11	SPEECH SERVICES
12	BOARD OFFICE
13	HEAD OF SCHOOL
14	CURRICULUM COORDINATOR
15	STAFF LOUNGE
16	CONFERENCE ROOM
17	MAINTENANCE
18	LIBRARY
19	BOOK STORAGE
20	MATH AND READING SPECIALIST
21	CR FOR INTERVENTION / TESTING
22	CR FOR STEM / COMPUTER LB
23	KINDERGARTEN
24	1ST GRADE
25	2ND GRADE
26	3RD GRADE
27	4TH GRADE
28	ART
29	LATIN
30	SPANISH
31	SPECIAL EDUCATION
32	5TH / 6TH GRADE SCIENCE
33	5TH / 6TH GRADE ENGLISH
34	5TH / 6TH GRADE MATHEMATICS
35	5TH / 6TH GRADE HISTORY
36	7TH / 8TH GRADE SCIENCE
37	7TH / 8TH GRADE ENGLISH
38	7TH / 8TH GRADE HISTORY
39	7TH / 8TH GRADE MATHEMATICS
40	GYM
41	PE OFFICE
42	BAND
43	MUSIC
44	CAFETERIA
45	ADJACENCIES
46	CONCEPTUAL FLOOR PLANS



323 W. Patrick Street
 Frederick, MD 21701
 (P) 301.698.0020
www.za-d.com



Room Name	Latin Classroom
Area Type	Classroom
Description	This classroom will be used for the understanding of the Latin language. Students will come here to not only learn how to work with the language but also to understand the importance of it.
Room SF	675
Room Count	1
Adjacency Requirements	-Latin should be located near the other special classrooms. - Should be easily reachable by all Age based classrooms -The language studies classes will be directly adjacent to one another -The library should also be close to the language studies classes as it will provide books in different languages
Security Requirements	-This room must have lockable doors. -Lockable Storage will be provided for teachers
Privacy Requirements	Door window covers should be provided for the event of a security breach or ease of distraction.
Furnishing and Equipment	-For learning purposes, it is important for these classes to be equipped with desks, a whiteboard, a projector and a promethean board. -Open faced bookshelves should be provided as storage for class books. -Teachers will have access to locked storage for personal use -Computers (2) will provide helpful for class projects due to in class internet accessibility
Lighting Requirements	This classroom should be provided with natural light
Electrical Requirements	Per Code
Mechanical Requirements	N/A
Special Requirements / Orientation	N/A

PAGE	NAME
1	COVER SHEET
2	INTRODUCTION
3-4	PROGRAM REQUIREMENTS
5	PROGRAM LAYOUT
6-7	SURVEY RESULTS
8	RECEPTION / ADMIN
9	NURSE
10	COUNSELOR
11	SPEECH SERVICES
12	BOARD OFFICE
13	HEAD OF SCHOOL
14	CURRICULUM COORDINATOR
15	STAFF LOUNGE
16	CONFERENCE ROOM
17	MAINTENANCE
18	LIBRARY
19	BOOK STORAGE
20	MATH AND READING SPECIALIST
21	CR FOR INTERVENTION / TESTING
22	CR FOR STEM / COMPUTER LB
23	KINDERGARTEN
24	1ST GRADE
25	2ND GRADE
26	3RD GRADE
27	4TH GRADE
28	ART
29	LATIN
30	SPANISH
31	SPECIAL EDUCATION
32	5TH / 6TH GRADE SCIENCE
33	5TH / 6TH GRADE ENGLISH
34	5TH / 6TH GRADE MATHEMATICS
35	5TH / 6TH GRADE HISTORY
36	7TH / 8TH GRADE SCIENCE
37	7TH / 8TH GRADE ENGLISH
38	7TH / 8TH GRADE HISTORY
39	7TH / 8TH GRADE MATHEMATICS
40	GYM
41	PE OFFICE
42	BAND
43	MUSIC
44	CAFETERIA
45	ADJACENCIES
46	CONCEPTUAL FLOOR PLANS



323 W. Patrick Street
 Frederick, MD 21701
 (P) 301.698.0020
www.za-d.com



Room Name	Spanish Classroom
Area Type	Classroom
Description	This classroom will be used for the understanding of the Spanish language. Students will come here to learn how to speak and write in Spanish. More importantly they will also be taught the culture of people that speak Spanish around the world.
Room SF	500
Room Count	1
Adjacency Requirements	<ul style="list-style-type: none"> -Spanish class should be located near the other special classrooms. - Should be easily reachable by all Age based classrooms -The language studies classes will be directly adjacent to one another -The library should also be close to the language studies classes as it will provide books in different languages
Security Requirements	<ul style="list-style-type: none"> -This room must have lockable doors. -Lockable Storage will be provided for teachers
Privacy Requirements	Door window covers should be provided for the event of a security breach or ease of distraction.
Furnishing and Equipment	<ul style="list-style-type: none"> -For learning purposes, it is important for these classes to be equipped with desks, a whiteboard, a projector and a promethean board. -Open faced bookshelves should be provided as storage for class books. -Teachers will have access to locked storage for personal use -Computers (2) will provide helpful for class projects due to in class internet accessibility
Lighting Requirements	This classroom should be provided with natural light
Electrical Requirements	Per Code
Mechanical Requirements	N/A
Special Requirements / Orientation	N/A

PAGE	NAME
1	COVER SHEET
2	INTRODUCTION
3-4	PROGRAM REQUIREMENTS
5	PROGRAM LAYOUT
6-7	SURVEY RESULTS
8	RECEPTION / ADMIN
9	NURSE
10	COUNSELOR
11	SPEECH SERVICES
12	BOARD OFFICE
13	HEAD OF SCHOOL
14	CURRICULUM COORDINATOR
15	STAFF LOUNGE
16	CONFERENCE ROOM
17	MAINTENANCE
18	LIBRARY
19	BOOK STORAGE
20	MATH AND READING SPECIALIST
21	CR FOR INTERVENTION / TESTING
22	CR FOR STEM / COMPUTER LB
23	KINDERGARTEN
24	1ST GRADE
25	2ND GRADE
26	3RD GRADE
27	4TH GRADE
28	ART
29	LATIN
30	SPANISH
31	SPECIAL EDUCATION
32	5TH / 6TH GRADE SCIENCE
33	5TH / 6TH GRADE ENGLISH
34	5TH / 6TH GRADE MATHEMATICS
35	5TH / 6TH GRADE HISTORY
36	7TH / 8TH GRADE SCIENCE
37	7TH / 8TH GRADE ENGLISH
38	7TH / 8TH GRADE HISTORY
39	7TH / 8TH GRADE MATHEMATICS
40	GYM
41	PE OFFICE
42	BAND
43	MUSIC
44	CAFETERIA
45	ADJACENCIES
46	CONCEPTUAL FLOOR PLANS



323 W. Patrick Street
 Frederick, MD 21701
 (P) 301.698.0020
www.za-d.com



Room Name Special Education w/ Conference Space

Area Type	Classroom
Description	Students from different grades will come here to experience different ways to learn. The class will specialize in individual needs as well as specialized subjects.
Room SF	500
Room Count	1
Adjacency Requirements	This room should be centralized or easily reachable by all classrooms. Due to the pulling students from each classroom all throughout the school it is important to make this room reachable without a long walk.
Security Requirements	-This room must have lockable doors. -Lockable Storage will be provided for teachers
Privacy Requirements	Door window covers should be provided for the event of a security breach or ease of distraction.
Furnishing and Equipment	-For learning purposes, it is important for these classes to be equipped with desks, a whiteboard, a projector and a promethean board. -Open faced bookshelves should be provided as storage for class books. -Teachers will have access to locked storage for personal use -Computers (2) will provide helpful for class projects due to in class internet accessibility
Lighting Requirements	This classroom should be provided with natural light
Electrical Requirements	Per Code
Mechanical Requirements	N/A
Special Requirements / Orientation	N/A

PAGE	NAME
1	COVER SHEET
2	INTRODUCTION
3-4	PROGRAM REQUIREMENTS
5	PROGRAM LAYOUT
6-7	SURVEY RESULTS
8	RECEPTION / ADMIN
9	NURSE
10	COUNSELOR
11	SPEECH SERVICES
12	BOARD OFFICE
13	HEAD OF SCHOOL
14	CURRICULUM COORDINATOR
15	STAFF LOUNGE
16	CONFERENCE ROOM
17	MAINTENANCE
18	LIBRARY
19	BOOK STORAGE
20	MATH AND READING SPECIALIST
21	CR FOR INTERVENTION / TESTING
22	CR FOR STEM / COMPUTER LB
23	KINDERGARTEN
24	1ST GRADE
25	2ND GRADE
26	3RD GRADE
27	4TH GRADE
28	ART
29	LATIN
30	SPANISH
31	SPECIAL EDUCATION
32	5TH / 6TH GRADE SCIENCE
33	5TH / 6TH GRADE ENGLISH
34	5TH / 6TH GRADE MATHEMATICS
35	5TH / 6TH GRADE HISTORY
36	7TH / 8TH GRADE SCIENCE
37	7TH / 8TH GRADE ENGLISH
38	7TH / 8TH GRADE HISTORY
39	7TH / 8TH GRADE MATHEMATICS
40	GYM
41	PE OFFICE
42	BAND
43	MUSIC
44	CAFETERIA
45	ADJACENCIES
46	CONCEPTUAL FLOOR PLANS



323 W. Patrick Street
 Frederick, MD 21701
 (P) 301.698.0020
www.za-d.com



Room Name **5th / 6th Grade Science**

Area Type Classroom

Description This classroom sets up the beginning of the students experience in a lab science. They will come here to go through the basics of science and will conduct experiments to further their understanding of certain topics.

Room SF 675

Room Count 1

Adjacency Requirements
 -This room should be farther away from the noise areas in the school (Gym, Music, and Cafeteria). As both can be used for testing. The computer lab can be used for online testing
 -Age Based Classrooms like this one should be adjacent to classrooms of the same grade. Beyond that the grades should be surrounded by the next closes grade on the younger and older side.
 -Directly adjacent to the 7th / 8th Science classroom

Security Requirements
 -This room must have lockable doors.
 -Lockable Storage will be provided for teachers

Privacy Requirements Door window covers should be provided for the event of a security breach or ease of distraction.

Furnishing and Equipment
 -For Protection it is important for Science classrooms to have the required protective gear such as eyewear. In case of accidents of failure to follow lab rules each lab must be equipped with eye washers and chemical showers.
 -For learning purposes, it is important for these classes to be equipped with desks, whiteboard, and promethean boards.
 -Two Separate locked storage will be provided for teachers. One to store Chemicals and lab equipment and the other will be used for personal use.
 -Computers will provide helpful for class projects due to in class internet accessibility

Lighting Requirements This classroom should be provided with natural light

Electrical Requirements Per Code

Mechanical Requirements Gas and gas burners are often used for experiments within the science classrooms so these rooms will be equipped with gas valves. For emergency use there will also be an emergency cut off valve and a nearby fire extinguisher.

Special Requirements / Orientation Each lab must be equipped with eye washers and chemical showers.

PAGE	NAME
1	COVER SHEET
2	INTRODUCTION
3-4	PROGRAM REQUIREMENTS
5	PROGRAM LAYOUT
6-7	SURVEY RESULTS
8	RECEPTION / ADMIN
9	NURSE
10	COUNSELOR
11	SPEECH SERVICES
12	BOARD OFFICE
13	HEAD OF SCHOOL
14	CURRICULUM COORDINATOR
15	STAFF LOUNGE
16	CONFERENCE ROOM
17	MAINTENANCE
18	LIBRARY
19	BOOK STORAGE
20	MATH AND READING SPECIALIST
21	CR FOR INTERVENTION / TESTING
22	CR FOR STEM / COMPUTER LB
23	KINDERGARTEN
24	1ST GRADE
25	2ND GRADE
26	3RD GRADE
27	4TH GRADE
28	ART
29	LATIN
30	SPANISH
31	SPECIAL EDUCATION
32	5TH / 6TH GRADE SCIENCE
33	5TH / 6TH GRADE ENGLISH
34	5TH / 6TH GRADE MATHEMATICS
35	5TH / 6TH GRADE HISTORY
36	7TH / 8TH GRADE SCIENCE
37	7TH / 8TH GRADE ENGLISH
38	7TH / 8TH GRADE HISTORY
39	7TH / 8TH GRADE MATHEMATICS
40	GYM
41	PE OFFICE
42	BAND
43	MUSIC
44	CAFETERIA
45	ADJACENCIES
46	CONCEPTUAL FLOOR PLANS



323 W. Patrick Street
 Frederick, MD 21701
 (P) 301.698.0020
www.za-d.com



Room Name 5th / 6th Grade English Language Arts

Area Type Classroom

Description This classroom will specialize in furthering the 5th and 6th grade students understanding of the English language. They will work towards better writing and more in-depth compositions.

Room SF 675

Room Count 1

Adjacency Requirements -This room should be farther away from the noise areas in the school (Gym, Music, and Cafeteria). As both can be used for testing. The computer lab can be used for online testing
 -Age Based Classrooms like this one should be adjacent to classrooms of the same grade. Beyond that the grades should be surrounded by the next closes grade on the younger and older side.
 -While it is important for the library to be reachable for all classes, the English department should be located in a close proximity to the library

Security Requirements -This room must have lockable doors.
 -Lockable Storage will be provided for teachers

Privacy Requirements Door window covers should be provided for the event of a security breach or ease of distraction.

Furnishing and Equipment -For learning purposes, it is important for these classes to be equipped with desks, a whiteboard, a projector and a promethean board.
 -Open faced bookshelves should be provided as storage for class books.
 -Teachers will have access to locked storage for personal use
 -Computers will provide helpful for class projects due to in class internet accessibility

Lighting Requirements This classroom should be provided with natural light

Electrical Requirements Per Code

Mechanical Requirements N/A

Special Requirements / Orientation N/A

PAGE	NAME
1	COVER SHEET
2	INTRODUCTION
3-4	PROGRAM REQUIREMENTS
5	PROGRAM LAYOUT
6-7	SURVEY RESULTS
8	RECEPTION / ADMIN
9	NURSE
10	COUNSELOR
11	SPEECH SERVICES
12	BOARD OFFICE
13	HEAD OF SCHOOL
14	CURRICULUM COORDINATOR
15	STAFF LOUNGE
16	CONFERENCE ROOM
17	MAINTENANCE
18	LIBRARY
19	BOOK STORAGE
20	MATH AND READING SPECIALIST
21	CR FOR INTERVENTION / TESTING
22	CR FOR STEM / COMPUTER LB
23	KINDERGARTEN
24	1ST GRADE
25	2ND GRADE
26	3RD GRADE
27	4TH GRADE
28	ART
29	LATIN
30	SPANISH
31	SPECIAL EDUCATION
32	5TH / 6TH GRADE SCIENCE
33	5TH / 6TH GRADE ENGLISH
34	5TH / 6TH GRADE MATHEMATICS
35	5TH / 6TH GRADE HISTORY
36	7TH / 8TH GRADE SCIENCE
37	7TH / 8TH GRADE ENGLISH
38	7TH / 8TH GRADE HISTORY
39	7TH / 8TH GRADE MATHEMATICS
40	GYM
41	PE OFFICE
42	BAND
43	MUSIC
44	CAFETERIA
45	ADJACENCIES
46	CONCEPTUAL FLOOR PLANS



323 W. Patrick Street
 Frederick, MD 21701
 (P) 301.698.0020
www.za-d.com



Room Name 5th / 6th Grade Mathematics

Area Type Classroom

Description This classroom will specialize in furthering the 5th and 6th grade students understanding of mathematics. They will experience new calculations, new terms, and many examples to support their understanding.

Room SF 675

Room Count 1

Adjacency Requirements
 -This room should be farther away from the noise areas in the school (Gym, Music, and Cafeteria). As both can be used for testing. The computer lab can be used for online testing
 -Age Based Classrooms like this one should be adjacent to classrooms of the same grade. Beyond that the grades should be surrounded by the next closes grade on the younger and older side.

Security Requirements
 -This room must have lockable doors.
 -Lockable Storage will be provided for teachers

Privacy Requirements Door window covers should be provided for the event of a security breach or ease of distraction.

Furnishing and Equipment
 -For learning purposes, it is important for these classes to be equipped with desks, a whiteboard, a projector and a promethean board.
 -Open faced bookshelves should be provided as storage for class books.
 -Teachers will have access to locked storage for personal use
 -Computers will provide helpful for class projects due to in class internet accessibility

Lighting Requirements This classroom should be provided with natural light

Electrical Requirements Per Code

Mechanical Requirements N/A

Special Requirements / Orientation N/A

PAGE	NAME
1	COVER SHEET
2	INTRODUCTION
3-4	PROGRAM REQUIREMENTS
5	PROGRAM LAYOUT
6-7	SURVEY RESULTS
8	RECEPTION / ADMIN
9	NURSE
10	COUNSELOR
11	SPEECH SERVICES
12	BOARD OFFICE
13	HEAD OF SCHOOL
14	CURRICULUM COORDINATOR
15	STAFF LOUNGE
16	CONFERENCE ROOM
17	MAINTENANCE
18	LIBRARY
19	BOOK STORAGE
20	MATH AND READING SPECIALIST
21	CR FOR INTERVENTION / TESTING
22	CR FOR STEM / COMPUTER LB
23	KINDERGARTEN
24	1ST GRADE
25	2ND GRADE
26	3RD GRADE
27	4TH GRADE
28	ART
29	LATIN
30	SPANISH
31	SPECIAL EDUCATION
32	5TH / 6TH GRADE SCIENCE
33	5TH / 6TH GRADE ENGLISH
34	5TH / 6TH GRADE MATHEMATICS
35	5TH / 6TH GRADE HISTORY
36	7TH / 8TH GRADE SCIENCE
37	7TH / 8TH GRADE ENGLISH
38	7TH / 8TH GRADE HISTORY
39	7TH / 8TH GRADE MATHEMATICS
40	GYM
41	PE OFFICE
42	BAND
43	MUSIC
44	CAFETERIA
45	ADJACENCIES
46	CONCEPTUAL FLOOR PLANS



323 W. Patrick Street
 Frederick, MD 21701
 (P) 301.698.0020
www.za-d.com



Room Name 5th / 6th Grade History

Area Type Classroom

Description This classroom will specialize in furthering the 5th and 6th grade students understanding of History.

Room SF 675

Room Count 1

Adjacency Requirements
 -This room should be farther away from the noise areas in the school (Gym, Music, and Cafeteria). As both can be used for testing. The computer lab can be used for online testing
 -Age Based Classrooms like this one should be adjacent to classrooms of the same grade. Beyond that the grades should be surrounded by the next closes grade on the younger and older side.

Security Requirements
 -This room must have lockable doors.
 -Lockable Storage will be provided for teachers

Privacy Requirements Door window covers should be provided for the event of a security breach or ease of distraction.

Furnishing and Equipment
 -For learning purposes, it is important for these classes to be equipped with desks, a whiteboard, a projector and a promethean board.
 -Open faced bookshelves should be provided as storage for class books.
 -Teachers will have access to locked storage for personal use
 -Computers will provide helpful for class projects due to in class internet accessibility

Lighting Requirements This classroom should be provided with natural light

Electrical Requirements Per Code

Mechanical Requirements N/A

Special Requirements / Orientation N/A

PAGE	NAME
1	COVER SHEET
2	INTRODUCTION
3-4	PROGRAM REQUIREMENTS
5	PROGRAM LAYOUT
6-7	SURVEY RESULTS
8	RECEPTION / ADMIN
9	NURSE
10	COUNSELOR
11	SPEECH SERVICES
12	BOARD OFFICE
13	HEAD OF SCHOOL
14	CURRICULUM COORDINATOR
15	STAFF LOUNGE
16	CONFERENCE ROOM
17	MAINTENANCE
18	LIBRARY
19	BOOK STORAGE
20	MATH AND READING SPECIALIST
21	CR FOR INTERVENTION / TESTING
22	CR FOR STEM / COMPUTER LB
23	KINDERGARTEN
24	1ST GRADE
25	2ND GRADE
26	3RD GRADE
27	4TH GRADE
28	ART
29	LATIN
30	SPANISH
31	SPECIAL EDUCATION
32	5TH / 6TH GRADE SCIENCE
33	5TH / 6TH GRADE ENGLISH
34	5TH / 6TH GRADE MATHEMATICS
35	5TH / 6TH GRADE HISTORY
36	7TH / 8TH GRADE SCIENCE
37	7TH / 8TH GRADE ENGLISH
38	7TH / 8TH GRADE HISTORY
39	7TH / 8TH GRADE MATHEMATICS
40	GYM
41	PE OFFICE
42	BAND
43	MUSIC
44	CAFETERIA
45	ADJACENCIES
46	CONCEPTUAL FLOOR PLANS



323 W. Patrick Street
 Frederick, MD 21701
 (P) 301.698.0020
www.za-d.com



Room Name **7th / 8th Grade Science**

Area Type Classroom

Description This classroom will specialize in furthering the 7th and 8th grade students understanding of Science. After taking lab science in their previous years they will experience more rigorous experiments.

Room SF 675

Room Count 1

Adjacency Requirements -This room should be farther away from the noise areas in the school (Gym, Music, and Cafeteria). As both can be used for testing. The computer lab can be used for online testing
 -Age Based Classrooms like this one should be adjacent to classrooms of the same grade. Beyond that the grades should be surrounded by the next closes grade on the younger and older side.
 -Directly adjacent to the 5th / 6th Science classroom

Security Requirements -This room must have lockable doors.
 -Lockable Storage will be provided for teachers

Privacy Requirements Door window covers should be provided for the event of a security breach or ease of distraction.

Furnishing and Equipment -For Protection it is important for Science classrooms to have the required protective gear such as eyewear. In case of accidents of failure to follow lab rules each lab must be equipped with eye washers and chemical showers.
 -For learning purposes, it is important for these classes to be equipped with desks, whiteboard, and promethean boards.
 -Two Separate locked storage will be provided for teachers. One to store Chemicals and lab equipment and the other will be used for personal use.
 -Computers will provide helpful for class projects due to in class internet accessibility

Lighting Requirements This classroom should be provided with natural light

Electrical Requirements Per Code

Mechanical Requirements Gas and gas burners are often used for experiments within the science classrooms so these rooms will be equipped with gas valves. For emergency use there will also be an emergency cut off valve and a nearby fire extinguisher.

Special Requirements / Orientation Each lab must be equipped with eye washers and chemical showers.

PAGE	NAME
1	COVER SHEET
2	INTRODUCTION
3-4	PROGRAM REQUIREMENTS
5	PROGRAM LAYOUT
6-7	SURVEY RESULTS
8	RECEPTION / ADMIN
9	NURSE
10	COUNSELOR
11	SPEECH SERVICES
12	BOARD OFFICE
13	HEAD OF SCHOOL
14	CURRICULUM COORDINATOR
15	STAFF LOUNGE
16	CONFERENCE ROOM
17	MAINTENANCE
18	LIBRARY
19	BOOK STORAGE
20	MATH AND READING SPECIALIST
21	CR FOR INTERVENTION / TESTING
22	CR FOR STEM / COMPUTER LB
23	KINDERGARTEN
24	1ST GRADE
25	2ND GRADE
26	3RD GRADE
27	4TH GRADE
28	ART
29	LATIN
30	SPANISH
31	SPECIAL EDUCATION
32	5TH / 6TH GRADE SCIENCE
33	5TH / 6TH GRADE ENGLISH
34	5TH / 6TH GRADE MATHEMATICS
35	5TH / 6TH GRADE HISTORY
36	7TH / 8TH GRADE SCIENCE
37	7TH / 8TH GRADE ENGLISH
38	7TH / 8TH GRADE HISTORY
39	7TH / 8TH GRADE MATHEMATICS
40	GYM
41	PE OFFICE
42	BAND
43	MUSIC
44	CAFETERIA
45	ADJACENCIES
46	CONCEPTUAL FLOOR PLANS



323 W. Patrick Street
 Frederick, MD 21701
 (P) 301.698.0020
www.za-d.com



Room Name 7th / 8th Grade English Language Arts

Area Type Classroom

Description This classroom will specialize in furthering the 7th and 8th grade students understanding of the English language. They will work towards better writing and more in-depth compositions.

Room SF 675

Room Count 1

Adjacency Requirements -This room should be farther away from the noise areas in the school (Gym, Music, and Cafeteria). As both can be used for testing. The computer lab can be used for online testing
 -Age Based Classrooms like this one should be adjacent to classrooms of the same grade. Beyond that the grades should be surrounded by the next closes grade on the younger and older side.
 -While it is important for the library to be reachable for all classes, the English department should be located in a close proximity to the library

Security Requirements -This room must have lockable doors.
 -Lockable Storage will be provided for teachers

Privacy Requirements Door window covers should be provided for the event of a security breach or ease of distraction.

Furnishing and Equipment -For learning purposes, it is important for these classes to be equipped with desks, a whiteboard, a projector and a promethean board.
 -Open faced bookshelves should be provided as storage for class books.
 -Teachers will have access to locked storage for personal use
 -Computers will provide helpful for class projects due to in class internet accessibility

Lighting Requirements This classroom should be provided with natural light

Electrical Requirements Per Code

Mechanical Requirements N/A

Special Requirements / Orientation N/A

PAGE	NAME
1	COVER SHEET
2	INTRODUCTION
3-4	PROGRAM REQUIREMENTS
5	PROGRAM LAYOUT
6-7	SURVEY RESULTS
8	RECEPTION / ADMIN
9	NURSE
10	COUNSELOR
11	SPEECH SERVICES
12	BOARD OFFICE
13	HEAD OF SCHOOL
14	CURRICULUM COORDINATOR
15	STAFF LOUNGE
16	CONFERENCE ROOM
17	MAINTENANCE
18	LIBRARY
19	BOOK STORAGE
20	MATH AND READING SPECIALIST
21	CR FOR INTERVENTION / TESTING
22	CR FOR STEM / COMPUTER LB
23	KINDERGARTEN
24	1ST GRADE
25	2ND GRADE
26	3RD GRADE
27	4TH GRADE
28	ART
29	LATIN
30	SPANISH
31	SPECIAL EDUCATION
32	5TH / 6TH GRADE SCIENCE
33	5TH / 6TH GRADE ENGLISH
34	5TH / 6TH GRADE MATHEMATICS
35	5TH / 6TH GRADE HISTORY
36	7TH / 8TH GRADE SCIENCE
37	7TH / 8TH GRADE ENGLISH
38	7TH / 8TH GRADE HISTORY
39	7TH / 8TH GRADE MATHEMATICS
40	GYM
41	PE OFFICE
42	BAND
43	MUSIC
44	CAFETERIA
45	ADJACENCIES
46	CONCEPTUAL FLOOR PLANS



323 W. Patrick Street
 Frederick, MD 21701
 (P) 301.698.0020
www.za-d.com



Room Name 7th / 8th Grade Mathematics

Area Type Classroom

Description This classroom will specialize in furthering the 7th and 8th grade students understanding of Mathematics. They will experience and further their understanding of algebra and geometry

Room SF 675

Room Count 1

Adjacency Requirements
 -This room should be farther away from the noise areas in the school (Gym, Music, and Cafeteria). As both can be used for testing. The computer lab can be used for online testing
 -Age Based Classrooms like this one should be adjacent to classrooms of the same grade. Beyond that the grades should be surrounded by the next closes grade on the younger and older side.

Security Requirements
 -This room must have lockable doors.
 -Lockable Storage will be provided for teachers

Privacy Requirements Door window covers should be provided for the event of a security breach or ease of distraction.

Furnishing and Equipment
 -For learning purposes, it is important for these classes to be equipped with desks, a whiteboard, a projector and a promethean board.
 -Open faced bookshelves should be provided as storage for class books.
 -Teachers will have access to locked storage for personal use
 -Computers will provide helpful for class projects due to in class internet accessibility

Lighting Requirements This classroom should be provided with natural light

Electrical Requirements Per Code

Mechanical Requirements N/A

Special Requirements / Orientation N/A

PAGE	NAME
1	COVER SHEET
2	INTRODUCTION
3-4	PROGRAM REQUIREMENTS
5	PROGRAM LAYOUT
6-7	SURVEY RESULTS
8	RECEPTION / ADMIN
9	NURSE
10	COUNSELOR
11	SPEECH SERVICES
12	BOARD OFFICE
13	HEAD OF SCHOOL
14	CURRICULUM COORDINATOR
15	STAFF LOUNGE
16	CONFERENCE ROOM
17	MAINTENANCE
18	LIBRARY
19	BOOK STORAGE
20	MATH AND READING SPECIALIST
21	CR FOR INTERVENTION / TESTING
22	CR FOR STEM / COMPUTER LB
23	KINDERGARTEN
24	1ST GRADE
25	2ND GRADE
26	3RD GRADE
27	4TH GRADE
28	ART
29	LATIN
30	SPANISH
31	SPECIAL EDUCATION
32	5TH / 6TH GRADE SCIENCE
33	5TH / 6TH GRADE ENGLISH
34	5TH / 6TH GRADE MATHEMATICS
35	5TH / 6TH GRADE HISTORY
36	7TH / 8TH GRADE SCIENCE
37	7TH / 8TH GRADE ENGLISH
38	7TH / 8TH GRADE HISTORY
39	7TH / 8TH GRADE MATHEMATICS
40	GYM
41	PE OFFICE
42	BAND
43	MUSIC
44	CAFETERIA
45	ADJACENCIES
46	CONCEPTUAL FLOOR PLANS



323 W. Patrick Street
 Frederick, MD 21701
 (P) 301.698.0020
www.za-d.com



Room Name 7th / 8th Grade History

Area Type Classroom

Description This classroom will specialize in furthering the 7th and 8th grade students understanding of History.

Room SF 675

Room Count 1

Adjacency Requirements
 -This room should be farther away from the noise areas in the school (Gym, Music, and Cafeteria). As both can be used for testing. The computer lab can be used for online testing
 -Age Based Classrooms like this one should be adjacent to classrooms of the same grade. Beyond that the grades should be surrounded by the next closes grade on the younger and older side.

Security Requirements
 -This room must have lockable doors.
 -Lockable Storage will be provided for teachers

Privacy Requirements Door window covers should be provided for the event of a security breach or ease of distraction.

Furnishing and Equipment
 -For learning purposes, it is important for these classes to be equipped with desks, a whiteboard, a projector and a promethean board.
 -Open faced bookshelves should be provided as storage for class books.
 -Teachers will have access to locked storage for personal use
 -Computers will provide helpful for class projects due to in class internet accessibility

Lighting Requirements This classroom should be provided with natural light

Electrical Requirements Per Code

Mechanical Requirements N/A

Special Requirements / Orientation N/A

PAGE	NAME
1	COVER SHEET
2	INTRODUCTION
3-4	PROGRAM REQUIREMENTS
5	PROGRAM LAYOUT
6-7	SURVEY RESULTS
8	RECEPTION / ADMIN
9	NURSE
10	COUNSELOR
11	SPEECH SERVICES
12	BOARD OFFICE
13	HEAD OF SCHOOL
14	CURRICULUM COORDINATOR
15	STAFF LOUNGE
16	CONFERENCE ROOM
17	MAINTENANCE
18	LIBRARY
19	BOOK STORAGE
20	MATH AND READING SPECIALIST
21	CR FOR INTERVENTION / TESTING
22	CR FOR STEM / COMPUTER LB
23	KINDERGARTEN
24	1ST GRADE
25	2ND GRADE
26	3RD GRADE
27	4TH GRADE
28	ART
29	LATIN
30	SPANISH
31	SPECIAL EDUCATION
32	5TH / 6TH GRADE SCIENCE
33	5TH / 6TH GRADE ENGLISH
34	5TH / 6TH GRADE MATHEMATICS
35	5TH / 6TH GRADE HISTORY
36	7TH / 8TH GRADE SCIENCE
37	7TH / 8TH GRADE ENGLISH
38	7TH / 8TH GRADE HISTORY
39	7TH / 8TH GRADE MATHEMATICS
40	GYM
41	PE OFFICE
42	BAND
43	MUSIC
44	CAFETERIA
45	ADJACENCIES
46	CONCEPTUAL FLOOR PLANS



323 W. Patrick Street
 Frederick, MD 21701
 (P) 301.698.0020
www.za-d.com



Room Name	Multi-purpose Room / GYM
Area Type	GYM
Description	The gym will be a place for students to get the exercise they need during the day. They will experience different tests to see where they stand in their physical fitness.
Room SF	3000
Room Count	1
Adjacency Requirements	-The PE Office is to be directly connected to the Gym. -The gym shall be separated from the classrooms due the volume level that can be reached in the gym.
Security Requirements	-This room must have lockable doors. -Lockable Storage will be provided for teachers and coaches
Privacy Requirements	N/A
Furnishing and Equipment	-The Gym shall be equipped with basketball hoops as well as volleyball posts. The remaining sporting equipment shall be stored -A utility closet shall be provided for the storing of Equipment such as balls, flags, ladders, and any other sporting equipment.
Lighting Requirements	There must be a lot of natural light that is indirect
Electrical Requirements	Per Code
Mechanical Requirements	N/A
Special Requirements / Orientation	N/A

PAGE	NAME
1	COVER SHEET
2	INTRODUCTION
3-4	PROGRAM REQUIREMENTS
5	PROGRAM LAYOUT
6-7	SURVEY RESULTS
8	RECEPTION / ADMIN
9	NURSE
10	COUNSELOR
11	SPEECH SERVICES
12	BOARD OFFICE
13	HEAD OF SCHOOL
14	CURRICULUM COORDINATOR
15	STAFF LOUNGE
16	CONFERENCE ROOM
17	MAINTENANCE
18	LIBRARY
19	BOOK STORAGE
20	MATH AND READING SPECIALIST
21	CR FOR INTERVENTION / TESTING
22	CR FOR STEM / COMPUTER LB
23	KINDERGARTEN
24	1ST GRADE
25	2ND GRADE
26	3RD GRADE
27	4TH GRADE
28	ART
29	LATIN
30	SPANISH
31	SPECIAL EDUCATION
32	5TH / 6TH GRADE SCIENCE
33	5TH / 6TH GRADE ENGLISH
34	5TH / 6TH GRADE MATHEMATICS
35	5TH / 6TH GRADE HISTORY
36	7TH / 8TH GRADE SCIENCE
37	7TH / 8TH GRADE ENGLISH
38	7TH / 8TH GRADE HISTORY
39	7TH / 8TH GRADE MATHEMATICS
40	GYM
41	PE OFFICE
42	BAND
43	MUSIC
44	CAFETERIA
45	ADJACENCIES
46	CONCEPTUAL FLOOR PLANS



323 W. Patrick Street
 Frederick, MD 21701
 (P) 301.698.0020
www.za-d.com



Room Name	PE Office
Area Type	GYM
Description	This room is a privatized office for teachers and coaches. Coaches and teachers will both be able to come plan in this office.
Room SF	150
Room Count	1
Adjacency Requirements	-The PE Office is to be directly connected to the Gym. -The gym and PE office shall be separated from the classrooms due the volume level that can be reached in the gym.
Security Requirements	-This room must have lockable doors. -Lockable Storage will be provided for teachers
Privacy Requirements	Blinds for staff working in the office
Furnishing and Equipment	-The offices will be equipped with desks, computers, and locked storage for physical education teachers and coaches.
Lighting Requirements	Lighting should be sufficient enough for work behind the closed blinds. When blinds are open light will flood in from the gym
Electrical Requirements	Per Code
Mechanical Requirements	N/A
Special Requirements / Orientation	N/A

PAGE	NAME
1	COVER SHEET
2	INTRODUCTION
3-4	PROGRAM REQUIREMENTS
5	PROGRAM LAYOUT
6-7	SURVEY RESULTS
8	RECEPTION / ADMIN
9	NURSE
10	COUNSELOR
11	SPEECH SERVICES
12	BOARD OFFICE
13	HEAD OF SCHOOL
14	CURRICULUM COORDINATOR
15	STAFF LOUNGE
16	CONFERENCE ROOM
17	MAINTENANCE
18	LIBRARY
19	BOOK STORAGE
20	MATH AND READING SPECIALIST
21	CR FOR INTERVENTION / TESTING
22	CR FOR STEM / COMPUTER LB
23	KINDERGARTEN
24	1ST GRADE
25	2ND GRADE
26	3RD GRADE
27	4TH GRADE
28	ART
29	LATIN
30	SPANISH
31	SPECIAL EDUCATION
32	5TH / 6TH GRADE SCIENCE
33	5TH / 6TH GRADE ENGLISH
34	5TH / 6TH GRADE MATHEMATICS
35	5TH / 6TH GRADE HISTORY
36	7TH / 8TH GRADE SCIENCE
37	7TH / 8TH GRADE ENGLISH
38	7TH / 8TH GRADE HISTORY
39	7TH / 8TH GRADE MATHEMATICS
40	GYM
41	PE OFFICE
42	BAND
43	MUSIC
44	CAFETERIA
45	ADJACENCIES
46	CONCEPTUAL FLOOR PLANS



323 W. Patrick Street
 Frederick, MD 21701
 (P) 301.698.0020
www.za-d.com



Room Name	Band Room
Area Type	Support
Description	The band room will be used by students in the band that want to improve their skills on whichever instrument they choose. The Band will practice here on specified days.
Room SF	850
Room Count	1
Adjacency Requirements	The band and music rooms shall be separated from the classrooms due the volume level reached in these spaces.
Security Requirements	-This room must have lockable doors. -Lockable Storage will be provided for teachers
Privacy Requirements	N/A
Furnishing and Equipment	-The band room will be equipped with a large instrumental storage. There will also be a smaller storage for the band teachers. -For learning purposes, it is important for this class to be equipped with chairs, a whiteboard, a projector and a promethean board
Lighting Requirements	The room must be well-lit with a lot of natural light.
Electrical Requirements	Per Code
Mechanical Requirements	N/A
Special Requirements / Orientation	N/A

PAGE	NAME
1	COVER SHEET
2	INTRODUCTION
3-4	PROGRAM REQUIREMENTS
5	PROGRAM LAYOUT
6-7	SURVEY RESULTS
8	RECEPTION / ADMIN
9	NURSE
10	COUNSELOR
11	SPEECH SERVICES
12	BOARD OFFICE
13	HEAD OF SCHOOL
14	CURRICULUM COORDINATOR
15	STAFF LOUNGE
16	CONFERENCE ROOM
17	MAINTENANCE
18	LIBRARY
19	BOOK STORAGE
20	MATH AND READING SPECIALIST
21	CR FOR INTERVENTION / TESTING
22	CR FOR STEM / COMPUTER LB
23	KINDERGARTEN
24	1ST GRADE
25	2ND GRADE
26	3RD GRADE
27	4TH GRADE
28	ART
29	LATIN
30	SPANISH
31	SPECIAL EDUCATION
32	5TH / 6TH GRADE SCIENCE
33	5TH / 6TH GRADE ENGLISH
34	5TH / 6TH GRADE MATHEMATICS
35	5TH / 6TH GRADE HISTORY
36	7TH / 8TH GRADE SCIENCE
37	7TH / 8TH GRADE ENGLISH
38	7TH / 8TH GRADE HISTORY
39	7TH / 8TH GRADE MATHEMATICS
40	GYM
41	PE OFFICE
42	BAND
43	MUSIC
44	CAFETERIA
45	ADJACENCIES
46	CONCEPTUAL FLOOR PLANS



323 W. Patrick Street
 Frederick, MD 21701
 (P) 301.698.0020
www.za-d.com



Room Name	Music Classroom
Area Type	Support
Description	Music class will take place in this room. It will give some students their first experience with instruments. They will learn to read notes and have a chance to see what type of instrument they might be interested in playing.
Room SF	1000
Room Count	1
Adjacency Requirements	The band and music rooms shall be separated from the classrooms due the volume level reached in these spaces.
Security Requirements	-This room must have lockable doors. -Lockable Storage will be provided for teachers
Privacy Requirements	N/A
Furnishing and Equipment	-The music room will be equipped with a large instrumental storage. There will also be a smaller storage for the music teachers. -For learning purposes, it is important for this class to be equipped with chairs, a whiteboard, a projector and a promethean board
Lighting Requirements	The room must be well-lit with a lot of natural light
Electrical Requirements	Per Code
Mechanical Requirements	N/A
Special Requirements / Orientation	N/A

PAGE	NAME
1	COVER SHEET
2	INTRODUCTION
3-4	PROGRAM REQUIREMENTS
5	PROGRAM LAYOUT
6-7	SURVEY RESULTS
8	RECEPTION / ADMIN
9	NURSE
10	COUNSELOR
11	SPEECH SERVICES
12	BOARD OFFICE
13	HEAD OF SCHOOL
14	CURRICULUM COORDINATOR
15	STAFF LOUNGE
16	CONFERENCE ROOM
17	MAINTENANCE
18	LIBRARY
19	BOOK STORAGE
20	MATH AND READING SPECIALIST
21	CR FOR INTERVENTION / TESTING
22	CR FOR STEM / COMPUTER LB
23	KINDERGARTEN
24	1ST GRADE
25	2ND GRADE
26	3RD GRADE
27	4TH GRADE
28	ART
29	LATIN
30	SPANISH
31	SPECIAL EDUCATION
32	5TH / 6TH GRADE SCIENCE
33	5TH / 6TH GRADE ENGLISH
34	5TH / 6TH GRADE MATHEMATICS
35	5TH / 6TH GRADE HISTORY
36	7TH / 8TH GRADE SCIENCE
37	7TH / 8TH GRADE ENGLISH
38	7TH / 8TH GRADE HISTORY
39	7TH / 8TH GRADE MATHEMATICS
40	GYM
41	PE OFFICE
42	BAND
43	MUSIC
44	CAFETERIA
45	ADJACENCIES
46	CONCEPTUAL FLOOR PLANS



323 W. Patrick Street
 Frederick, MD 21701
 (P) 301.698.0020
www.za-d.com



Room Name	Cafeteria
Area Type	Communal
Description	Students from each grade will gather here at different points of the day to have a break from learning while they eat and interact with fellow students.
Room SF	2150
Room Count	1
Adjacency Requirements	-The Cafeteria shall be separated from the classrooms due the volume level reached in these spaces. -Directly connected to the cafeteria will be the kitchen which will be provided with cooking supplies and equipment
Security Requirements	-This room must have lockable doors. -Lockable Storage will be provided for Cooks
Privacy Requirements	N/A
Furnishing and Equipment	-The cafeteria will be provided with foldable tables that will provide seating for all grades - The kitchen will also be supplied with storage and frozen storage.
Lighting Requirements	The room must be well-lit with a lot of natural light.
Electrical Requirements	Per Code
Mechanical Requirements	Kitchen Equipment and freezers must be supplied with enough power
Special Requirements / Orientation	N/A

PAGE	NAME
1	COVER SHEET
2	INTRODUCTION
3-4	PROGRAM REQUIREMENTS
5	PROGRAM LAYOUT
6-7	SURVEY RESULTS
8	RECEPTION / ADMIN
9	NURSE
10	COUNSELOR
11	SPEECH SERVICES
12	BOARD OFFICE
13	HEAD OF SCHOOL
14	CURRICULUM COORDINATOR
15	STAFF LOUNGE
16	CONFERENCE ROOM
17	MAINTENANCE
18	LIBRARY
19	BOOK STORAGE
20	MATH AND READING SPECIALIST
21	CR FOR INTERVENTION / TESTING
22	CR FOR STEM / COMPUTER LB
23	KINDERGARTEN
24	1ST GRADE
25	2ND GRADE
26	3RD GRADE
27	4TH GRADE
28	ART
29	LATIN
30	SPANISH
31	SPECIAL EDUCATION
32	5TH / 6TH GRADE SCIENCE
33	5TH / 6TH GRADE ENGLISH
34	5TH / 6TH GRADE MATHEMATICS
35	5TH / 6TH GRADE HISTORY
36	7TH / 8TH GRADE SCIENCE
37	7TH / 8TH GRADE ENGLISH
38	7TH / 8TH GRADE HISTORY
39	7TH / 8TH GRADE MATHEMATICS
40	GYM
41	PE OFFICE
42	BAND
43	MUSIC
44	CAFETERIA
45	ADJACENCIES
46	CONCEPTUAL FLOOR PLANS



323 W. Patrick Street
 Frederick, MD 21701
 (P) 301.698.0020
www.za-d.com



SPACE ADJACENCY MATRIX:

Space Name	1	2	3	4	5	6	7	8	9	10	11	12	13	14	15	16	17	18	19	20	
	LIBRARY	K- 4TH GRADE CLM	5TH-8TH GRADE CLM	BAND ROOM	GYM	MUSIC	PE OFFICE	CAFETERIA	ART CLASS	LATIN CLASS	SPANISH CLASS	SPECIAL ED	STEM/COMPUTER LAB	INTERVENTION/ TEST	MATH/READING SPEC.	BOOK STORAGE	MAINTENANCE	STAFF LOUNGE	CONFERENCE ROOM	FRONT OFFICE (ALL.)	
1 LIBRARY																					
2 K- 4TH GRADE CLM																					
3 5TH-8TH GRADE CLM																					
4 BAND ROOM																					
5 GYM																					
6 MUSIC																					
7 PE OFFICE																					
8 CAFETERIA																					
9 ART CLASS																					
10 LATIN CLASS																					
11 SPANISH CLASS																					
12 SPECIAL ED																					
13 STEM/COMPUTER LAB																					
14 INTERVENTION/ TEST																					
15 MATH/READING SPEC.																					
16 BOOK STORAGE																					
17 MAINTENANCE																					
18 STAFF LOUNGE																					
19 CONFERENCE ROOM																					
20 FRONT OFFICE (ALL.)																					

- LEGEND:
- SPACES SHOULD BE DIRECTLY NEXT TO EACH OTHER
 - SPACES SHOULD BE NEAR EACH OTHER
 - NO SPECIAL AJACENCY NEEDS
 - SAME ROOM
 - DUPLICATE RELATIONSHIP

PAGE	NAME
1	COVER SHEET
2	INTRODUCTION
3-4	PROGRAM REQUIREMENTS
5	PROGRAM LAYOUT
6-7	SURVEY RESULTS
8	RECEPTION / ADMIN
9	NURSE
10	COUNSELOR
11	SPEECH SERVICES
12	BOARD OFFICE
13	HEAD OF SCHOOL
14	CURRICULUM COORDINATOR
15	STAFF LOUNGE
16	CONFERENCE ROOM
17	MAINTENANCE
18	LIBRARY
19	BOOK STORAGE
20	MATH AND READING SPECIALIST
21	CR FOR INTERVENTION / TESTING
22	CR FOR STEM / COMPUTER LB
23	KINDERGARTEN
24	1ST GRADE
25	2ND GRADE
26	3RD GRADE
27	4TH GRADE
28	ART
29	LATIN
30	SPANISH
31	SPECIAL EDUCATION
32	5TH / 6TH GRADE SCIENCE
33	5TH / 6TH GRADE ENGLISH
34	5TH / 6TH GRADE MATHEMATICS
35	5TH / 6TH GRADE HISTORY
36	7TH / 8TH GRADE SCIENCE
37	7TH / 8TH GRADE ENGLISH
38	7TH / 8TH GRADE HISTORY
39	7TH / 8TH GRADE MATHEMATICS
40	GYM
41	PE OFFICE
42	BAND
43	MUSIC
44	CAFETERIA
45	ADJACENCIES
46	CONCEPTUAL FLOOR PLANS

CONCEPTUAL FLOOR PLANS TO AID SITE SELECTION:

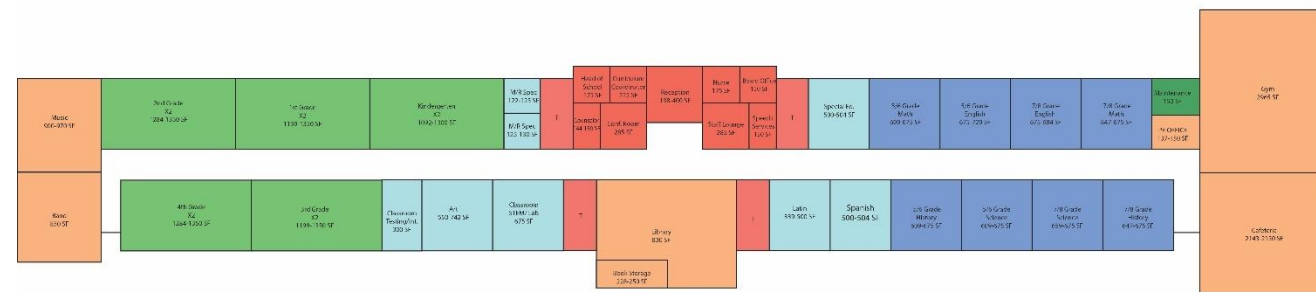
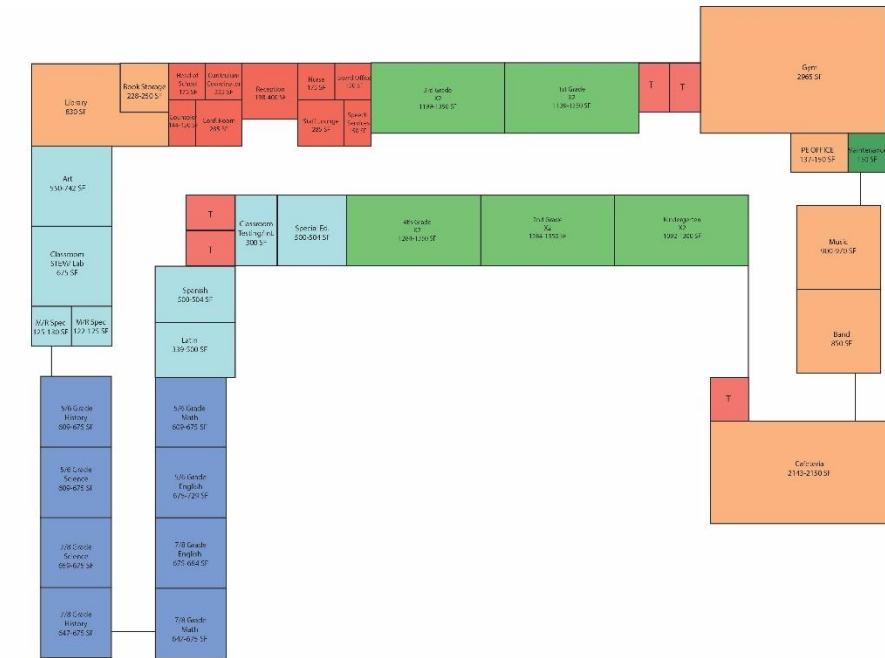
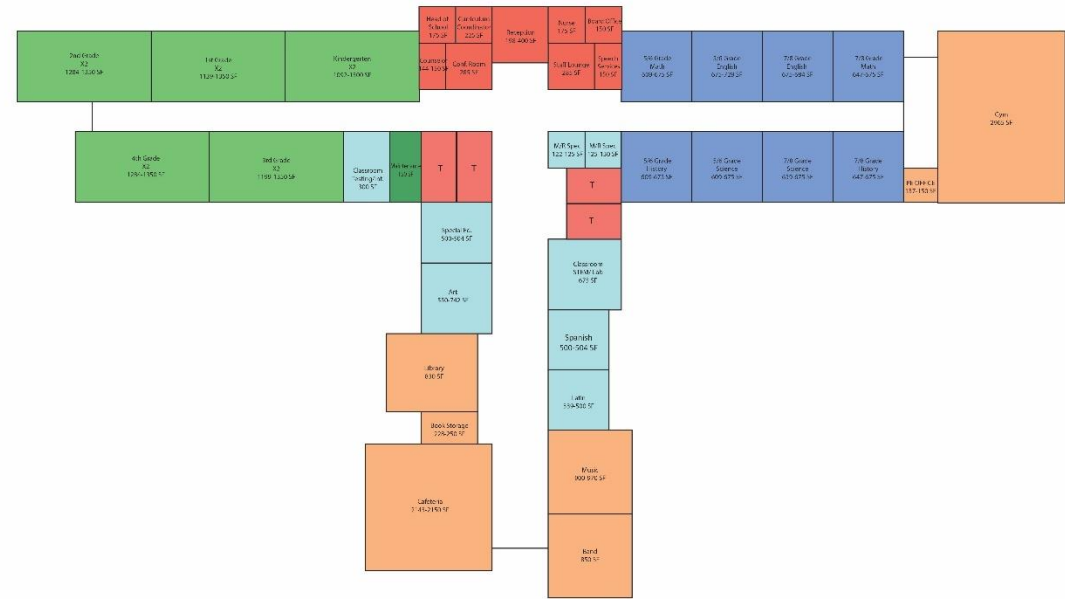

PAGE	NAME
1	COVER SHEET
2	INTRODUCTION
3-4	PROGRAM REQUIREMENTS
5	PROGRAM LAYOUT
6-7	SURVEY RESULTS
8	RECEPTION / ADMIN
9	NURSE
10	COUNSELOR
11	SPEECH SERVICES
12	BOARD OFFICE
13	HEAD OF SCHOOL
14	CURRICULUM COORDINATOR
15	STAFF LOUNGE
16	CONFERENCE ROOM
17	MAINTENANCE
18	LIBRARY
19	BOOK STORAGE
20	MATH AND READING SPECIALIST
21	CR FOR INTERVENTION / TESTING
22	CR FOR STEM / COMPUTER LB
23	KINDERGARTEN
24	1ST GRADE
25	2ND GRADE
26	3RD GRADE
27	4TH GRADE
28	ART
29	LATIN
30	SPANISH
31	SPECIAL EDUCATION
32	5TH / 6TH GRADE SCIENCE
33	5TH / 6TH GRADE ENGLISH
34	5TH / 6TH GRADE MATHEMATICS
35	5TH / 6TH GRADE HISTORY
36	7TH / 8TH GRADE SCIENCE
37	7TH / 8TH GRADE ENGLISH
38	7TH / 8TH GRADE HISTORY
39	7TH / 8TH GRADE MATHEMATICS
40	GYM
41	PE OFFICE
42	BAND
43	MUSIC
44	CAFETERIA
45	ADJACENCIES
46	CONCEPTUAL FLOOR PLANS